

# | Products Catalogue







# Index

## GENERALS

- ▶ **Product families** p. 4
- ▶ **Fields of application** p. 5

## MODELS

- ▶ **UP** p. 6
- ▶ **DL** p. 10
- ▶ **UPRT** p. 14

## TECHNICAL SPECIFICATIONS

- ▶ **Safety devices** p. 18
- ▶ **Operator-on-board system** p. 22
- ▶ **Available Outfittings** p. 24
- ▶ **Surfaces** p. 26
- ▶ **Shaft** p. 28
- ▶ **Landing doors** p. 30

## TECHNICAL DRAWINGS

- ▶ **UP3-6** p. 34
- ▶ **UP10-15** p. 36
- ▶ **UP20-25** p. 38
- ▶ **DL2 Smart** p. 40
- ▶ **DL2** p. 42
- ▶ **DL4** p. 44
- ▶ **UP3RT** p. 46
- ▶ **UP5-10RT** p. 47
- ▶ **UP15-20RT** p. 48

# Three product families to fully meet any market requirement and provide versatile and innovative industrial goods-lifts.

UP

## One-column goods-lift for goods and attendant

- from 300 Kgs to 2500 Kgs
- travel up to 16 metres
- certified for transport of one operator on board (attended)

DL

## 2 and 4 columns goods-lift for goods and attendant

- from 3000 Kgs to 5000 Kgs
- travel up to 16 metres
- certified for transport of one operator on board (attended)

UPRT

## Goods-lifts with retractable roof that disappear underground

- from 300 Kgs to 2000 Kgs
- travel up to 16 metres
- certified for transport of one operator on board (attended)

### Applicable Regulation

All our goods-lifts comply with **Machinery Directive 2006/42/EC**. They also have the **EC type examination certificate** issued by a Notified Body.

# Fields of application

Our goods-lifts can be applied to several fields, such as small commercial activities, retailers, logistics up to large-scale industries.

Tailor made solutions, with specific equipment for every sector of application.

- ▶ LOGISTICS
- ▶ LARGE DISTRIBUTION
- ▶ MANUFACTURING SECTOR
- ▶ FOOD INDUSTRY
- ▶ AGRI-FOOD INDUSTRY
- ▶ FOOD AND WINE INDUSTRY
- ▶ CHEMICAL INDUSTRY
- ▶ WOOD AND FURNITURE INDUSTRY
- ▶ AUTOMOTIVE





ES

# One-column hydraulic lifting system certified for transport of goods and one operator on board, with capacity ratings starting from 300 Kgs up to 2500 Kgs.

## UP for goods-only

It optimises the loading surface for the material only and is suitable for connecting several levels with operators at the floors.

**Suitable to be used also in automated industrial plants.**

## UP SPB with operator on board

It allows the operator to manoeuvre the **system safely while on board**. Moreover, it permits to reduce the loading/unloading operations timings.

<b>UP3</b>	<b>UP6</b>	<b>UP10</b>	<b>UP15</b>	<b>UP20</b>	<b>UP25</b>
300 Kgs	600 Kgs	1000 Kgs	1500 Kgs	2000 Kgs	2500 Kgs

# UP - Models and main technical features

	UP3	UP6	UP10	UP15	UP20	UP25
Max capacity [Kgs]	300	600	1000	1500	2000	2500
<b>C</b> Max travel [m]	7	7	16	16	16	16
Number of stops	5	5	5	5	5	5
Accesses	1/2/3	1/2/3	1/2/3	1/2/3	1/2/3	1/2/3
<b>P</b> Platform depth [mm]	1300	1300	2000/2500	1700/1900	2000/2400	1800/2000
<b>L</b> Platform width [mm]	1700	1700	2800/2500	2500/1900	2800/2400	2500/2000
<b>F</b> Pit [mm]	120	120	150	150	250	250
<b>T</b> Min headroom [mm]	2150	2150	2150	2150	2150	2150
<b>J</b> Brackets distance [mm]	600	600	1000	1000	1000	1000
<b>S</b> Guide gauge [mm]	660	660	1000	1000	1000	1000
Fx Each cylinder load [KN]	12	18	30	35	40	45
Minimum speed [m/s]	0.10	0.10	0.10	0.10	0.10	0.10
Max speed [m/s]	0.15	0.15	0.15	0.15	0.15	0.15
Floor operation	Automatic	Automatic	Automatic	Automatic	Automatic	Automatic
On-board operation	Operator on board	Operator on board	Operator on board	Operator on board	Operator on board	Operator on board
Power supply	Single-phase	Single-phase	Three-phase	Three-phase	Three-phase	Three-phase
Switchboard	Pre-wired	Pre-wired	Pre-wired	Pre-wired	Pre-wired	Pre-wired
Clamping levelling device (standard)	1	1	2	2	2	2
Additional mechanical hooks (total)	3	3	4	4	4	4
Anchoring walls	1	1	1	1	1	1
Cylinder	1	1	1	1	1	1
Basic Motor [kW]	1.5	2.2	3	4	4	5.5
Hydraulic oil	Supplied ISO32	Supplied ISO32	Supplied ISO32	Supplied ISO32	Supplied ISO32	Supplied ISO32
Pipe length [mm]	4000	4000	4000	4000	4000	4000
Maximum working pressure [bar]	80	95/115	90/120/140	110/145/180	145/195	165



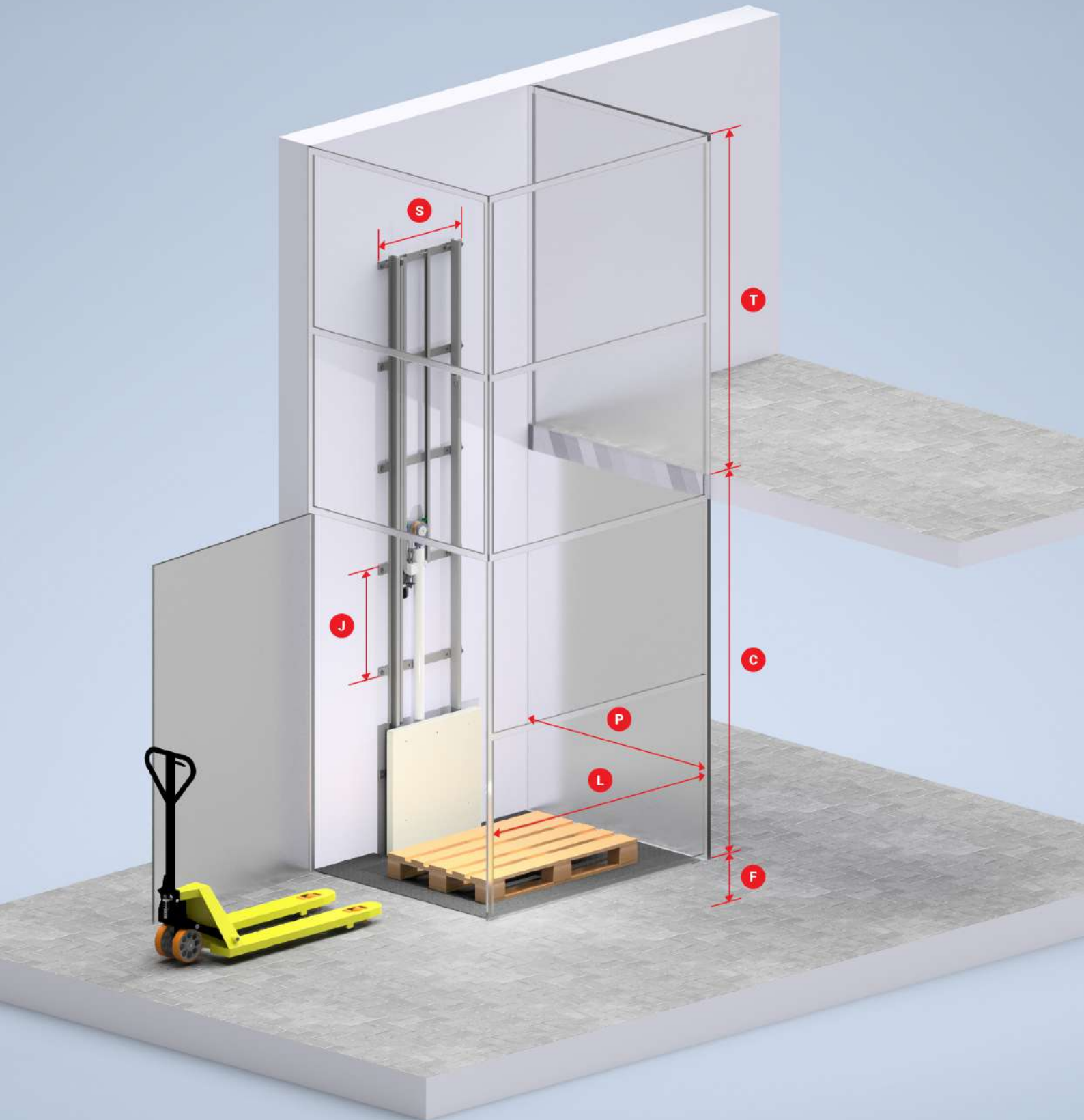

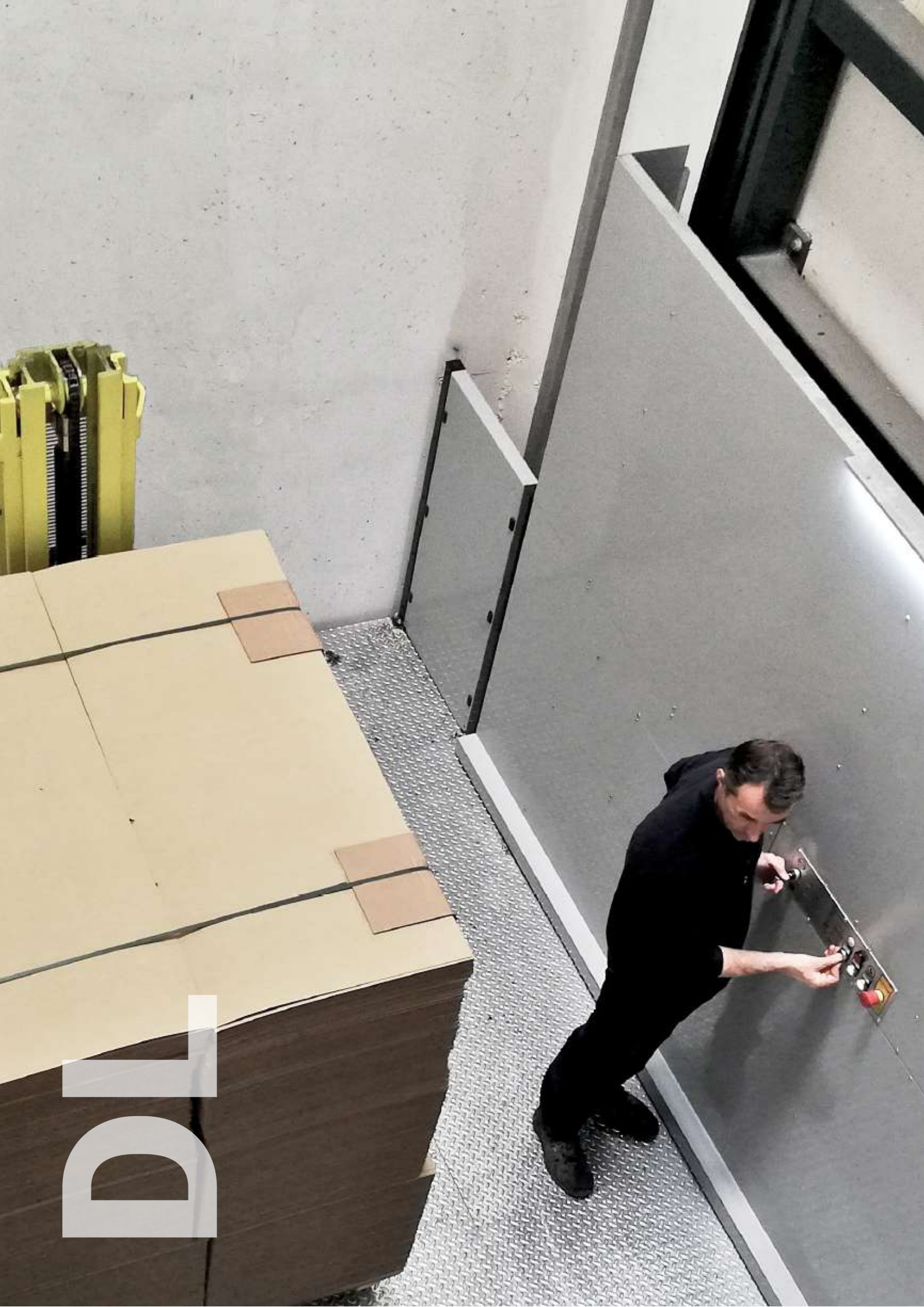

DL

# 2- and 4-columns hydraulic lifting system certified for the transport of goods and one operator on board, with capacity ratings from 3000 Kgs up to 5000 Kgs.

## DL for goods only

It optimises the loading surface for the material only and is suitable for connecting several levels with operators at the floors. Possibility to reach a **capacity up to 5000 Kgs or more.**

## DL SPB with operator on board

It allows the operator to **manoeuvre the system safely while on board.** Thanks to its platform robustness is **suitable to transport also a forklift truck and the operator.**

<b>DL2 Smart</b> 3000 Kgs	<b>DL2</b> 3000/4000 Kgs	<b>DL4</b> 4000/5000 Kgs
------------------------------	-----------------------------	-----------------------------

# DL - Models and main technical features

	DL2 Smart	DL2		DL4	
Max capacity [Kgs]	3000	3000	4000	4000	5000
<b>C</b> Max travel [m]	16	16	16	16	16
Number of stops	5	5	5	5	5
Accesses	1/2/3	1/2/3	1/2/3	1/2/3	1/2/3
<b>P</b> Platform depth [mm]	2500	3000	2500	3000	3000
<b>L</b> Platform width [mm]	4500	6000	4500	6000	6000
<b>F</b> Pit [mm]	260	260	260	1150	1150
<b>T</b> Min headroom [mm]	2300	2300	2300	2300	2300
<b>J</b> Brackets distance [mm]	1000	1000	1000	1000	1000
<b>S</b> Guide gauge [mm]	2100	2900	2900	2500	2500
Fx Each cylinder load [KN]	38	40	48	25	30
Minimum speed [m/s]	0,10	0,10	0,10	0,10	0,10
Max speed [m/s]	0.15	0.15	0.15	0.15	0.15
Floor operation	Automatic	Automatic	Automatic	Automatic	Automatic
On-board operation	Operator on board	Operator on board	Operator on board	Operator on board	Not available
Power supply	Three-phase	Three-phase	Three-phase	Three-phase	Three-phase
Switchboard	Pre-wired	Pre-wired	Pre-wired	Pre-wired	Pre-wired
Clamping levelling device (standard)	4	4	4	4	4
Additional mechanical hooks (total)	8	8	8	4	4
Anchoring walls	1	1	1	2	2
Cylinder	2	2	2	4	4
Basic Motor [kW]	4	5.5	5.5	5.5	7.5
Hydraulic oil	Supplied ISO32	Supplied ISO32	Supplied ISO32	Supplied ISO32	Supplied ISO32
Pipe length [mm]	6000	6000	6000	6000	6000
Maximum working pressure [bar]	130	145	170	140	160

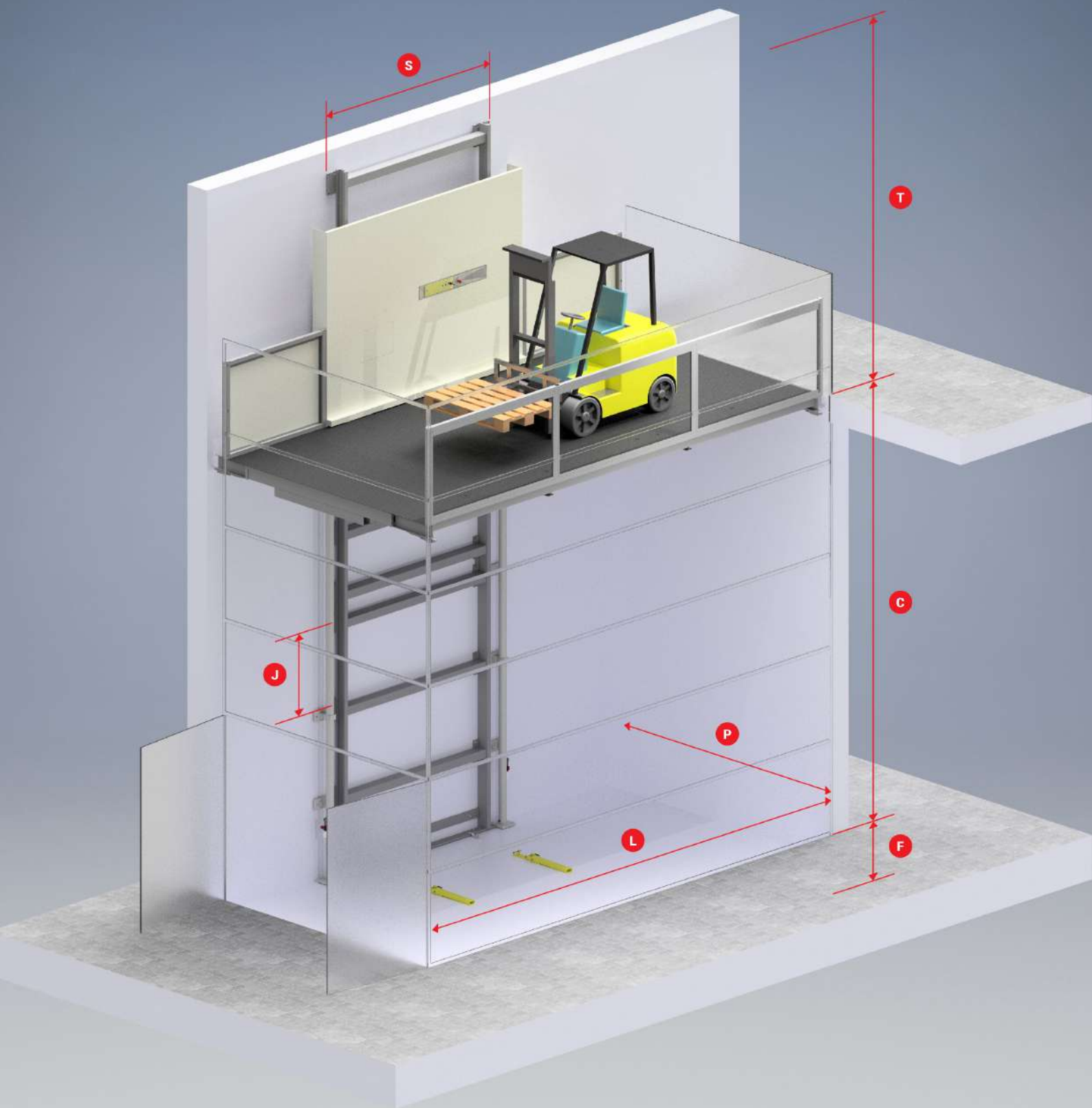

# UP RT



# Single-column hydraulic system with retractable roof and cabin for indoor or outdoor installations.

## UPRT for goods only

The upper surface of the roof becomes a walkable and driveable **flooring of the upper floor. It can be equipped with a rainwater collection perimetral channel in case of outdoor installations.**

The manoeuvre must be performed only from the upper floor with deadman control.

## UPRT SPB with operator on board

The retractable roof solution is **certified for use with operator on board** foreseeing perimetral protections at the upper floor.

**The operating manoeuvre is attended from on-board of the cabin and it is automatic on the floors.**

<b>UP3RT</b>	<b>UP5RT</b>	<b>UP10RT</b>	<b>UP15RT</b>	<b>UP20RT</b>
300 Kgs	500 Kgs	1000 Kgs	1500 Kgs	2000 Kgs

# UPRT - Models and main technical features

	UP3RT	UP5RT	UP10RT	UP15RT	UP20RT
Max capacity [Kgs]	300	500	1000	1500	2000
<b>C</b> Max travel [m]	7	16	16	16	16
Number of stops	5	5	5	5	5
Accesses	1/2/3	1/2/3	1/2/3	1/2/3	1/2/3
<b>P</b> Platform depth [mm]	1300	2000/2500	1700/1900	2000/2400	1700/2000
<b>L</b> Platform width [mm]	1700	2800/2500	2500/1900	2800/2400	2500/2000
<b>F</b> Pit [mm]	975	1400	1400	1400	1400
<b>T</b> Min headroom [mm]	Free	Free	Free	Free	Free
<b>J</b> Brackets distance [mm]	600	1000	1000	1000	1000
<b>S</b> Guide gauge [mm]	660	1000	1000	1000	1000
Fx Each cylinder load [KN]	18	30	35	40	45
Minimum speed [m/s]	0.10	0.10	0.10	0.10	0.10
Max speed [m/s]	0.15	0.15	0.15	0.15	0.15
Floor operation	Automatic	Automatic	Automatic	Automatic	Automatic
On-board operation	Operator on board	Operator on board	Operator on board	Operator on board	Operator on board
Power supply	Single-phase	Three-phase	Three-phase	Three-phase	Three-phase
Switchboard	Pre-wired	Pre-wired	Pre-wired	Pre-wired	Pre-wired
Clamping levelling device (standard)	1	2	2	2	2
Additional mechanical hooks (total)	3	4	4	4	4
Anchoring walls	1	1	1	1	1
Cylinder	1	1	1	1	1
Basic Motor [kW]	2.2	3	4	4	5.5
Hydraulic oil	Supplied ISO32	Supplied ISO32	Supplied ISO32	Supplied ISO32	Supplied ISO32
Pipe length [mm]	4000	4000	4000	4000	4000
Maximum working pressure [bar]	120	140	180	195	165



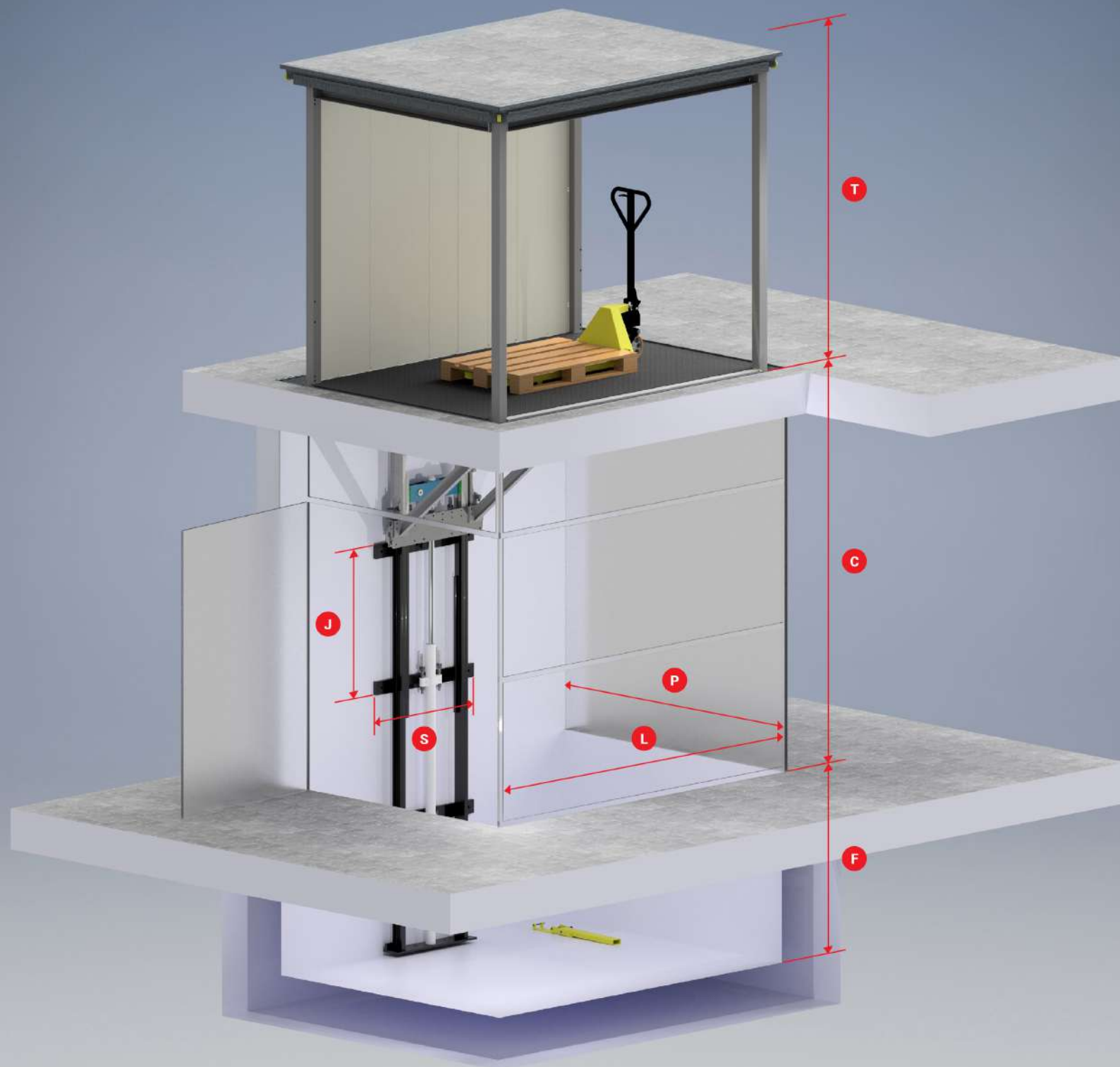

safety





## Safety devices

We are strongly focused on safety and for this reason we design our systems including numerous safety devices as standard equipment:

- 1 DOUBLE CHAIN FLEYER
- 2 BLOCK VALVE
- 3 MICROPROCESSOR LOGIC
- 4 PARKING HOOKS
- 5 ELECTRIC SAFETY INTERLOCKS
- 6 PIT STRUT
- 7 COMBINED BEARINGS

### 1 Lifting with double Fleyer chain

Double chain for each cylinder, very high traction resistance and reduced deformation in lengthening.



## 2 Flanged block valve on the cylinder

It checks the hydraulic flow in case of rupture of the piping and does not allow unauthorised personnel to tamper with it.

## 3 Operating logic with microprocessor

High reliability microprocessor smart card combined with a safety circuit to manage the system operation.

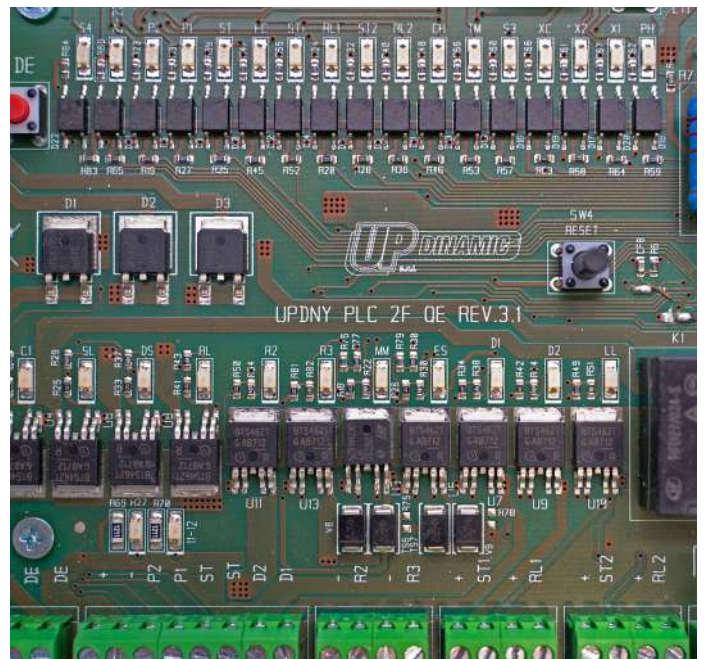

## 4 Clamping levelling device

Standard equipment installed on all systems to avoid bending and ensure a stable platform during loading/unloading operations at the floors. It guarantees a perfect levelling with the landing level and prevent loss of car.

## 5 Industrial electric safety interlocks

Safety switches equipped with RFID technology and high level coded actuator controlled by a safety module. Actuator flexible bolt for inaccurately closing doors and guarantees a strong holding force. High protection degree IP67 and dustproof.



## 6 Pit strut

It allows the maintenance technician to inspect the pit safely. It is controlled by an electric contact to switch the system off.

## 7 Combined bearings

They are self-lubricated and suitable for withstanding radial and axial loads. They ensure the sliding on the C-guides, which are made of special drawn steel.

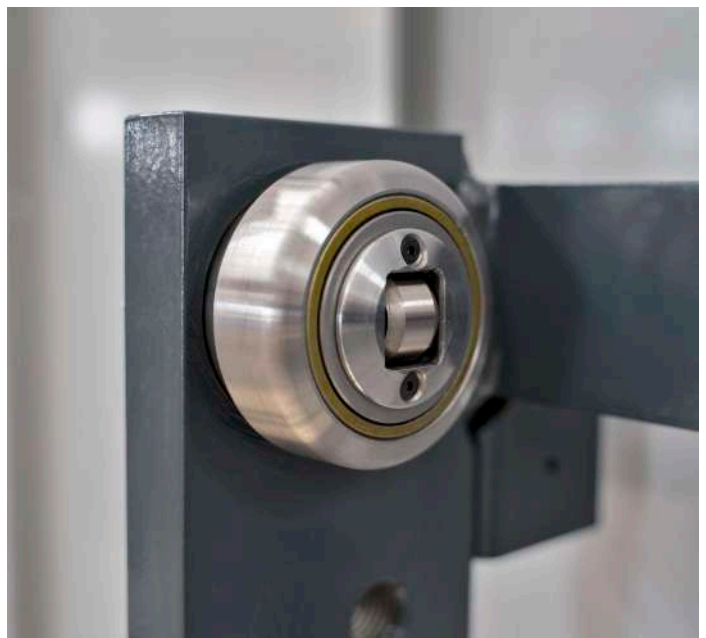



## Operator on-board

All our goods-lifts are certified for the operator on board control.

This option has a specific outfitting which includes:

- 1 PROTECTION PANEL
- 2 PUSHBUTTON PANEL COMMAND
- 3 PERIMETRAL PHOTOCELLS
- 4 CHAIN LOOSENING SENSOR

### 1 Protection panel

The protection of the operator from moving parts is guaranteed by a 1800mm high panel made in painted metal sheet.

## 2 Pushbutton panel comand

Pushbutton panel with dual control held simultaneously (hold to run) to ensure the operator safety.  
Emergency dialer system landline or GSM.  
Command of automatic descent to the lower floor in case of power failure.

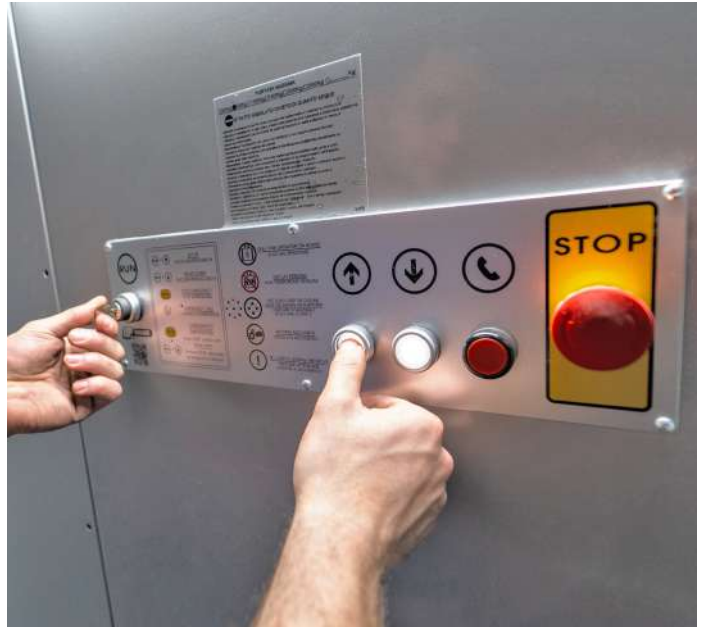

## 3 Perimetral photocells

Perimeter of the platform controlled by double ray photocells to ensure the on board correct position of the goods and the operator safety.



## 4 Chain loosening sensor

The safety coefficient of the chains is above 8. Moreover, a sensor controls the slackening of each single chain.



Outfitting

## Outfittings

The standard system includes the lifting platform which can be equipped with different accessories:

- 1 ON BOARD PARAPETS
- 2 CABIN
- 3 ADDITIONAL MECHANICAL HOOKS
- 4 CABINET

### 1 On board Parapets

Available 1100 mm (standard height) or 1800 mm (maximum height). Parapets are made of blind metal sheet cladding painted RAL 9006 and are installed on board on 1 to 3 sides of the platform.



## 2 Solid cabins for industrial use

Available with an height of 2100 mm or 2300 mm they are made of blind metal sheet cladding (paint RAL 9006). Equipped with photocell barrier on the access sides and a led strip lighting system.

REDUCED GOODS-LIFT CAPACITY WITH CABIN

UP6	UP10	UP15	UP20	UP25
300 Kgs	500 Kgs	1000 Kgs	1500 Kgs	2000 Kgs



## 3 Additional mechanical hooks

For big platform dimensions, they improve the stability during loading and unloading operation. They are recommended in case of loading with electric forklift or forklift trucks.

## 4 Cabinet

Industrial single-block cabinet with hydraulic control unit support, internal led lighting system and ventilation system.





## Surfaces

Are available different surface treatments suitable for any application. Hot dip galvanisation for system exposed to bad weather conditions or where are required higher protection from aggressive agents.

Elements such as sliding guides and cylinders can be treated with special paints such as antiacid zinc primer or marine cycle paint for greater resistance to saline atmosphere. For food industries all surfaces can be made of Stainless Steel AISI class 304 or 316.

- 1 STANDARD PAINTING
- 2 SPECIAL PAINTINGS
- 3 HOT DIP GALVANISATION
- 4 STAINLESS STEEL

### 1 Standard painting

Epoxy powder paint available in standard colours RAL7016, RAL9006 metallic.

## 2 Special paintings

Painting customised or special RAL for corrosive environments with anti-acid zinc or marine primer.



## 3 Hot dip galvanisation

Appropriate for outdoor or humid locations. Hot dip galvanisation ensures higher corrosion resistance.

## 4 Stainless steel

Appropriate for food industries, Stainless Steel is available on class 304 or 316 with the possibility of smooth or embossed metal sheet.





## Shaft

The goods-lift shaft must comply with the norm UNI-EN-ISO-13857:2080.

When protections are made of wire mesh, it is necessary to use a 12x12 mm dense wire mesh at a distance of 50mm from the shaft. The anchoring walls can be of different nature:

- 1 REINFORCED CONCRETE SHAFT
- 2 METAL STRUCTURE SHAFT
- 3 HEA BEAMS

### 1 Reinforced concrete shaft

The anchoring wall must be made of reinforced concrete class C20/25. Appropriate mechanical plugs are provided.

## 2 Metal structure shaft

In the absence of a bearing wall, we can provide a metal structure anchored on the pit and on landing floors. It is made of painted steel profiles and covered in blind metal sheet cladding or metal mesh.



## 3 HEA beams

In the presence of a bearing ceiling, the system can be fastened to 2 HEA beams. The client is in charge of arranging the profiles based on Updynamic designs.

### Recommended beams

### Maximum span [mm]

<b>UP3</b>	HEA 120	6000
<b>UP6</b>	HEA 120	6000
<b>UP10</b>	HEA 160	4000
<b>UP15</b>	HEA 160	4000
<b>UP20</b>	HEA 160	3000
<b>UP25</b>	HEA 160	3000
<b>DL2 Smart</b>	HEA 240	3000
<b>DL2</b>	HEA 240	3000
<b>DL4</b>	HEA 240	3000



## Landing doors

Based on their location it is possible to supply different types of landing doors (manual or automatic) always in compliance with safety regulations and the customer's needs.

- 1 MANUAL SWING DOORS
- 2 SEMI-AUTOMATIC DOORS
- 3 AUTOMATIC INDUSTRIAL DOORS
- 4 CARPENTRY CLOSURES

### 1 Manual swing doors single or double leaf

Maximum dimensions 2600 x 2600 mm.  
Controlled by a standard safety electric interlock.

Available also Fire rated versions, EI60/ EI120.  
Standard colour: RAL 7035.

## 2 Semi-automatic single or double leaf doors

Maximum dimensions 2600 x 2600 mm.  
Controlled by integrated safety interlock like Kronenberg, Prudhomme, Tieffe.  
Standard versions, fire rated EI60, EI120.  
Standard colour: RAL 7035.



## 3 Automatic industrial doors

Maximum dimensions 6000x5000 mm.  
Controlled by an interface card for the disconnection of the motor power supply and safety magnetic contact closure control with RFID technology.  
Versions with roller shutter, sectional door.  
Standard colour: RAL 9006.



## 4 Carpentry closures

Doors and gates made in metallic carpentry.  
Controlled by standard safety electric interlock.  
Versions with perforated mesh or blind metal sheet cladding.  
Standard colour: RAL 7016.



# drawing







PREPARE TUBULAR 100x40 FLUSH  
WITH THE GOODS LIFT ROOM  
Only for standard door application

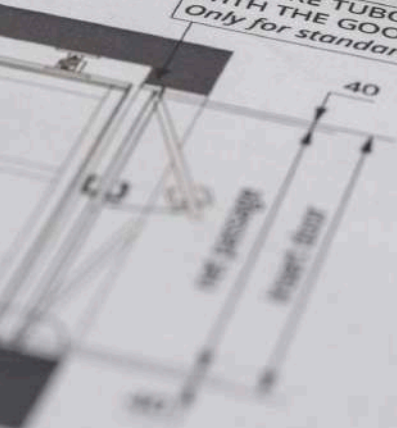

... IN THE ENTRANCES AND THE HEIG

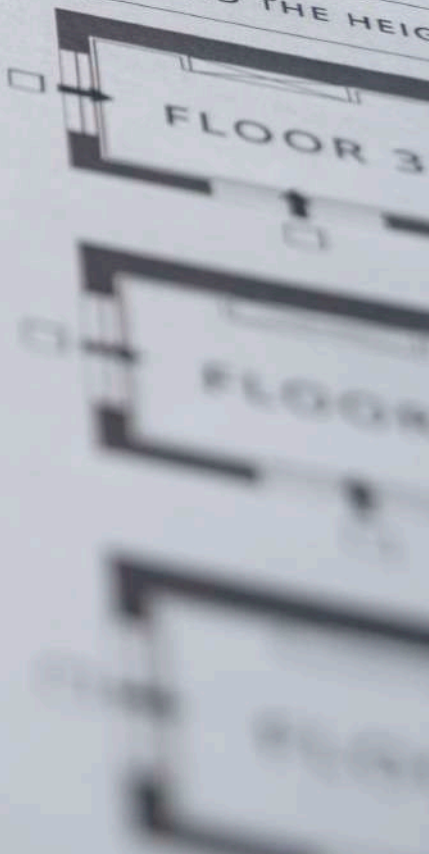

## UP3-6 STD for goods only

## UP3-6 SPB with operator on board

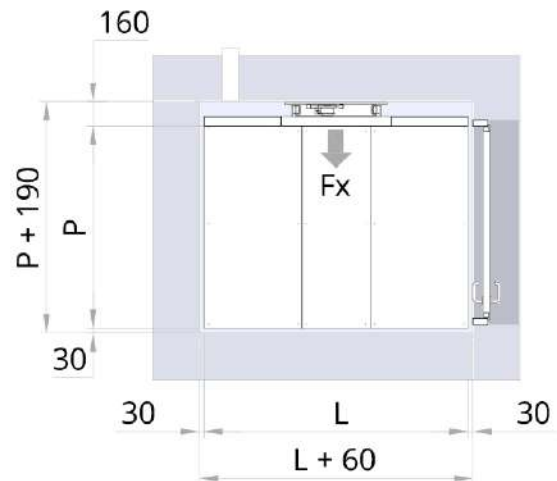
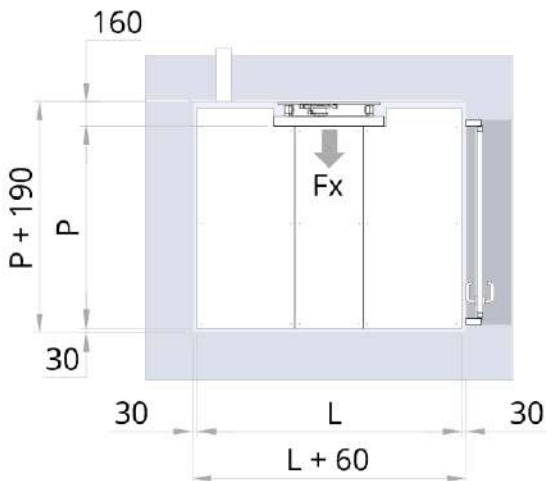
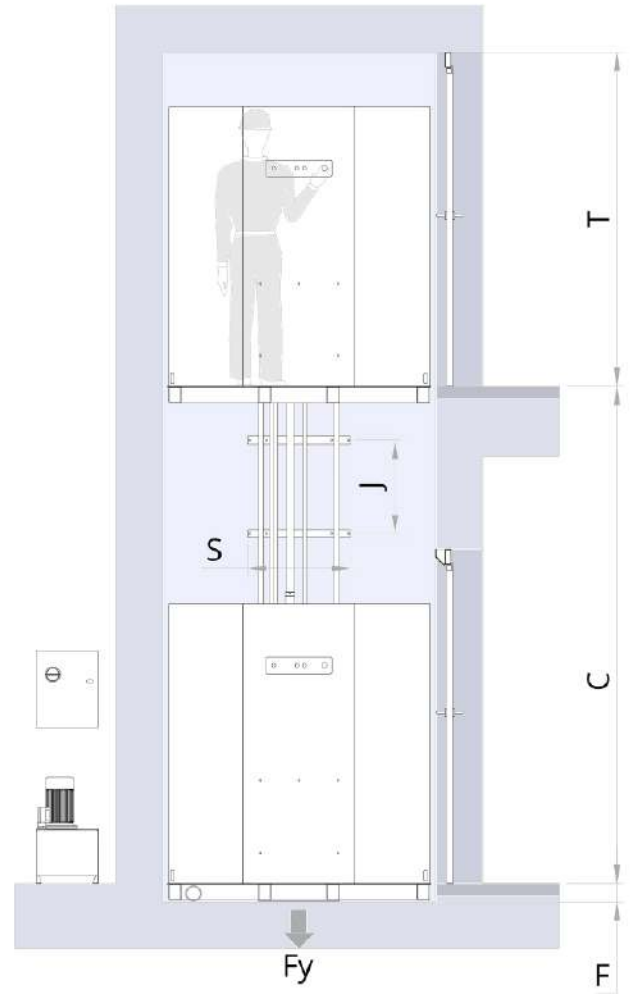
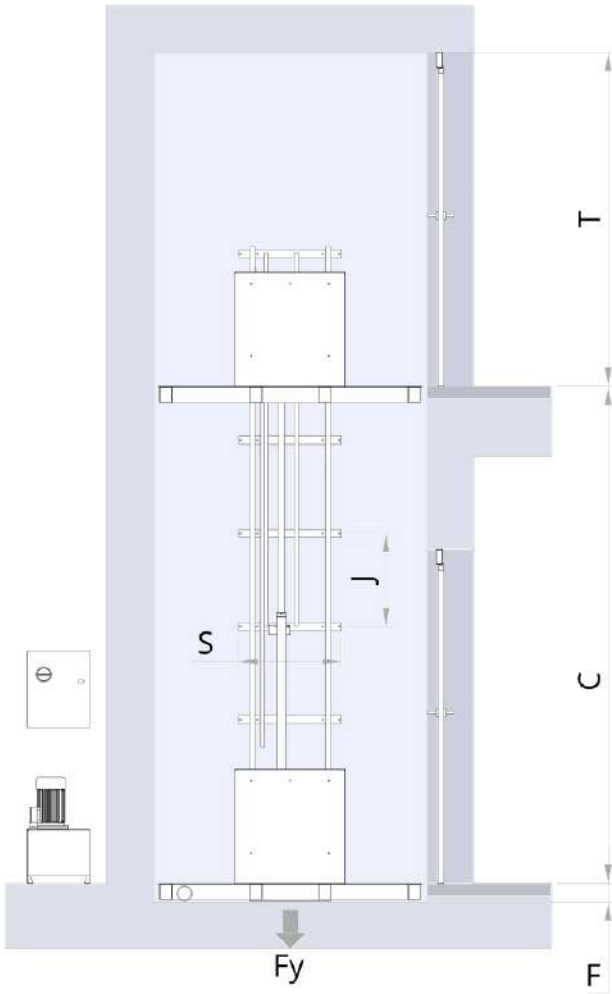

Max dimensions

Loads on wall (Fx)

FLATBED DIMENSION AND MAX STROKE

Model	D (mm)	W (mm)	MAX S (mm)
UP3	1700	1300	7000
UP6	1700	1300	7000

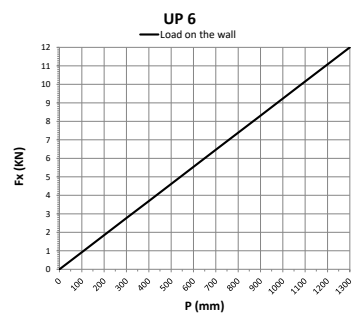
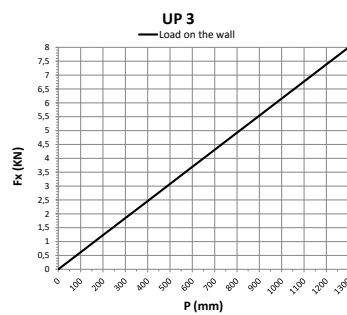

## UP3-6 R STD for goods only with reverse trolley

## UP3-6 R SPB with operator on board and reverse trolley

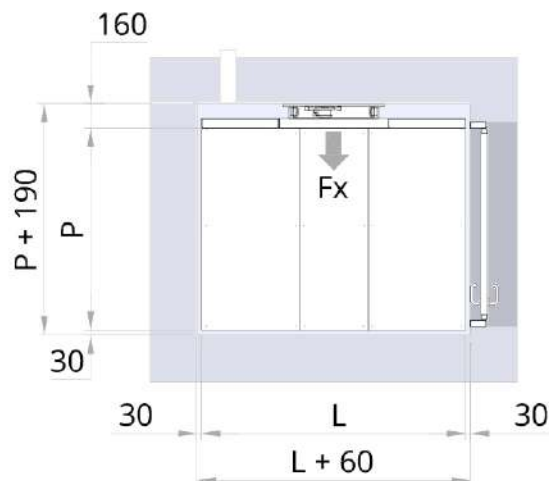
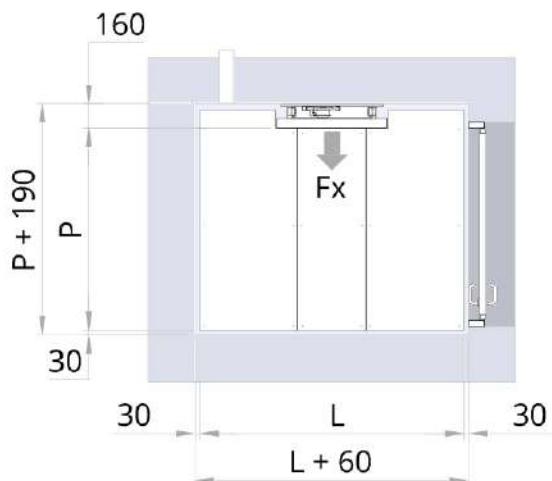
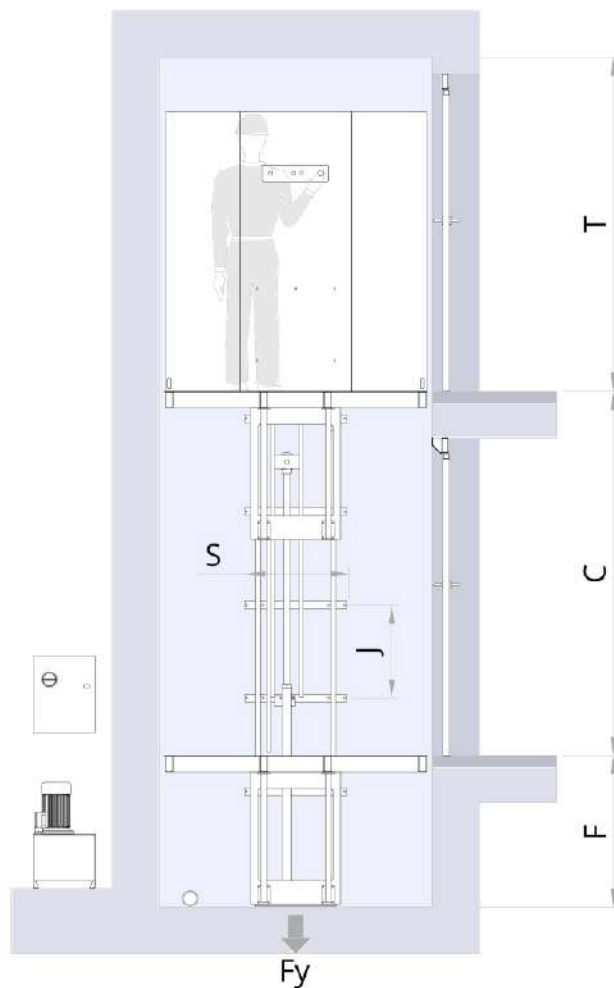
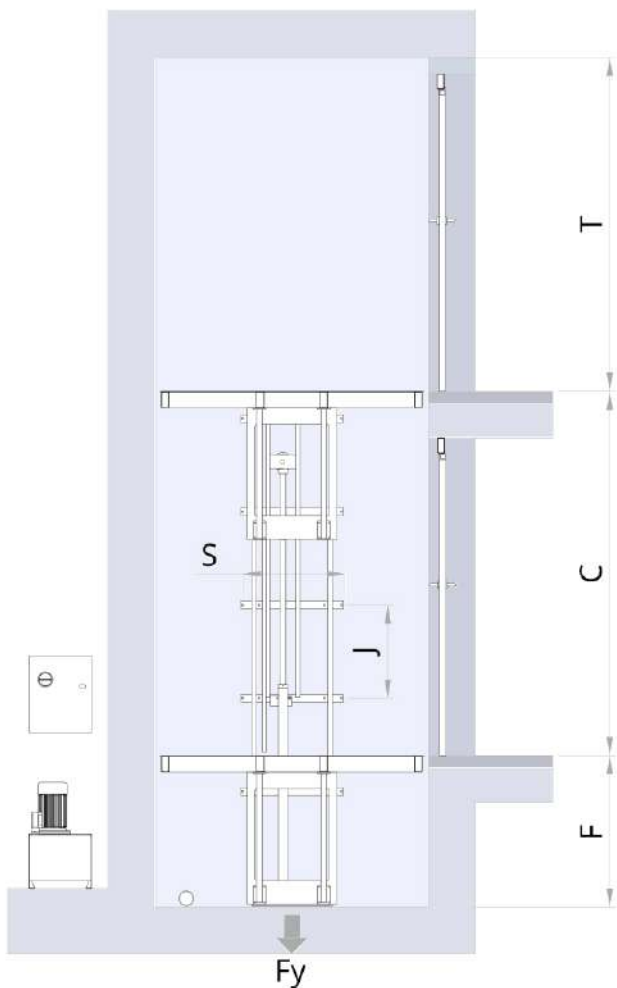

### System arrangement

PREPARE POWER PH+T+N SWITCH AUTOMATIC MAGNETOTHERMIC WITH DIFFERENTIAL CURVE "C", ID = 0,3A

Motor	Tension functioning	Starter	Suggested switch*	Rated current	Current starter
1,5 kW	220 V - 1ph	Direct	2x16A id=0,3A	9,5	28
2,2 kW	220 V - 1ph	Direct	2x16A id=0,3A	10,5	32

# UP10-15 STD or goods only

# UP10-15 SPB with operator on board

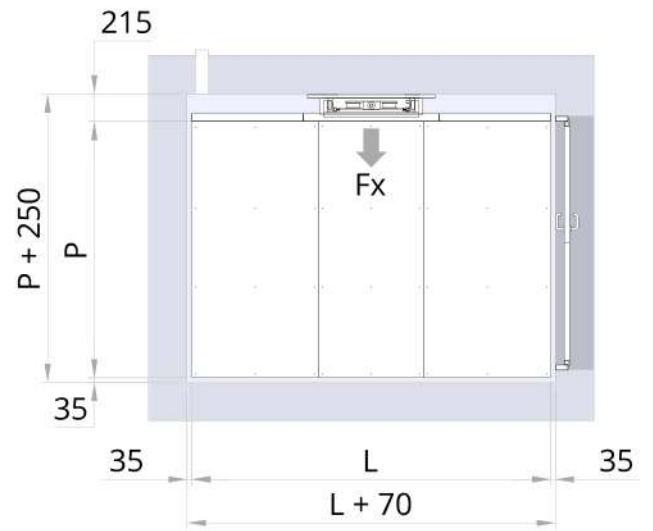
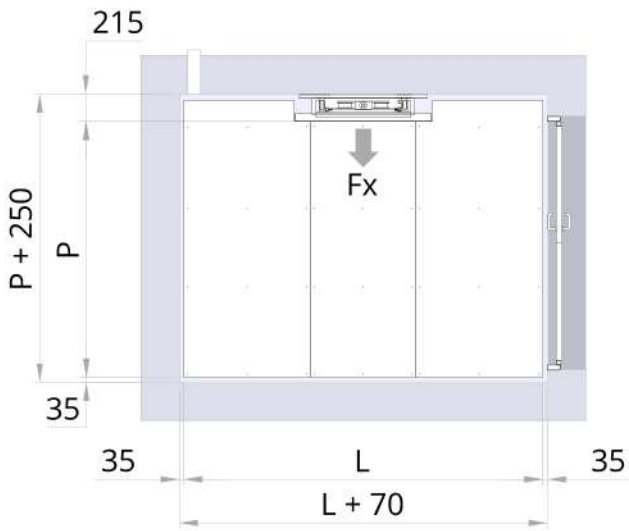
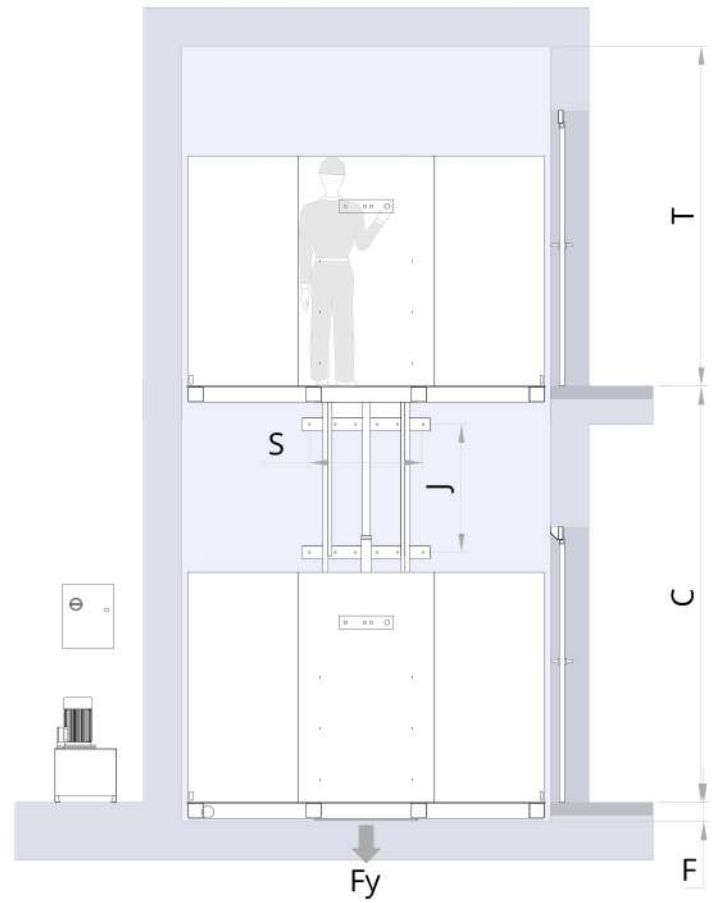
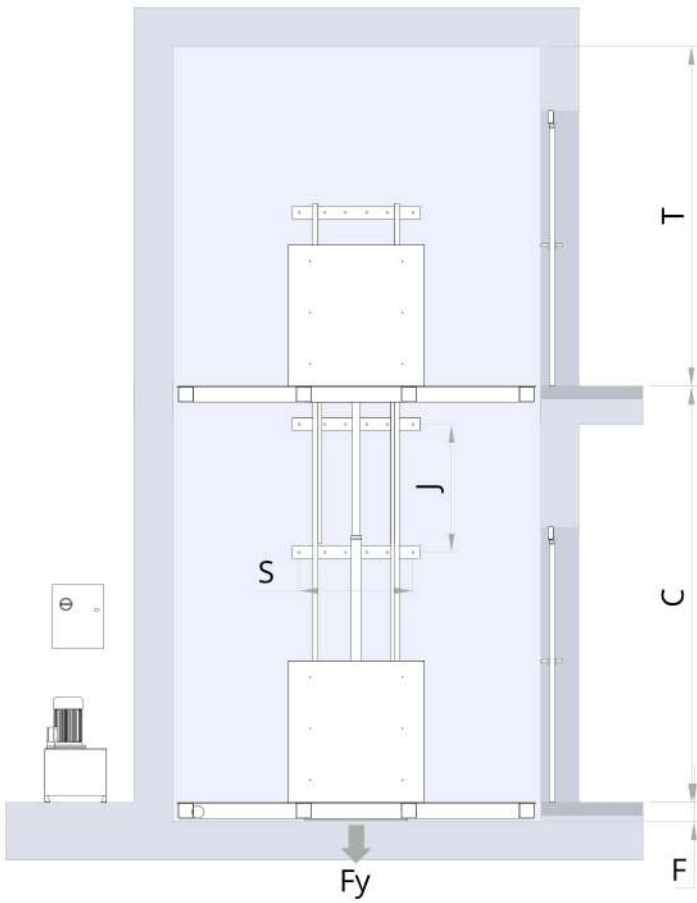

## Max dimensions

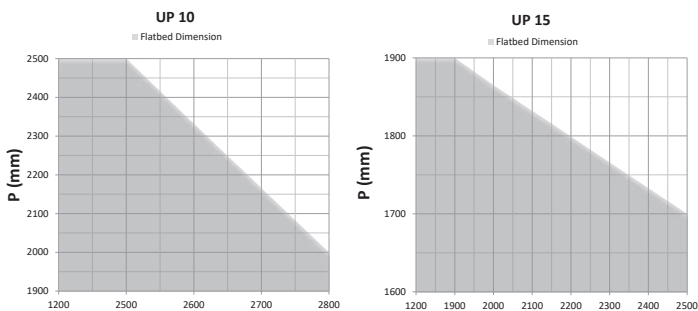

## Loads on wall (Fx)

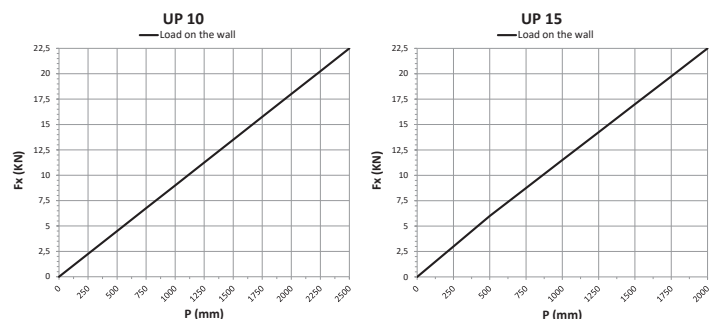

## UP10-15 R STD for goods only with reverse trolley

## UP10-15 R SPB with operator on board and reverse trolley

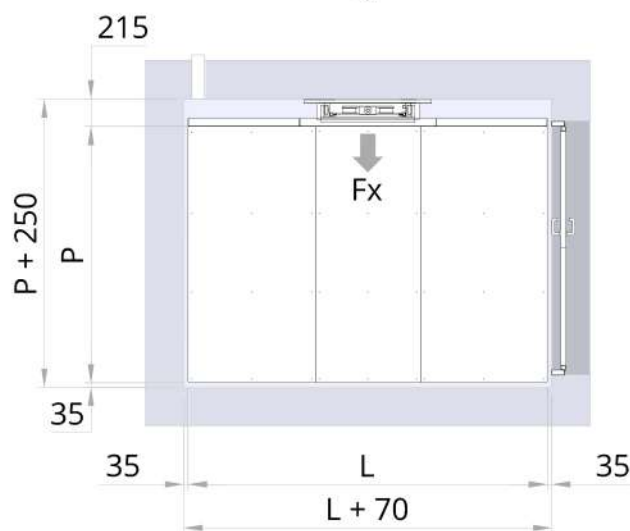
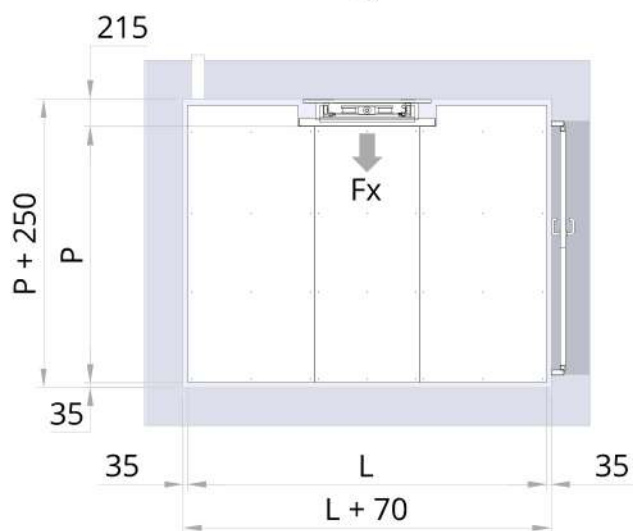
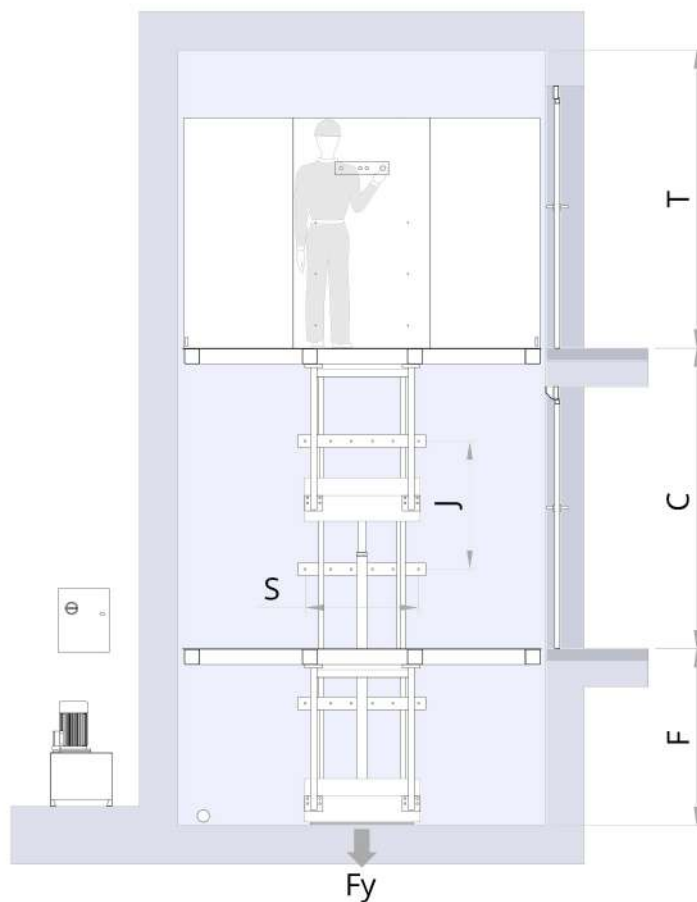
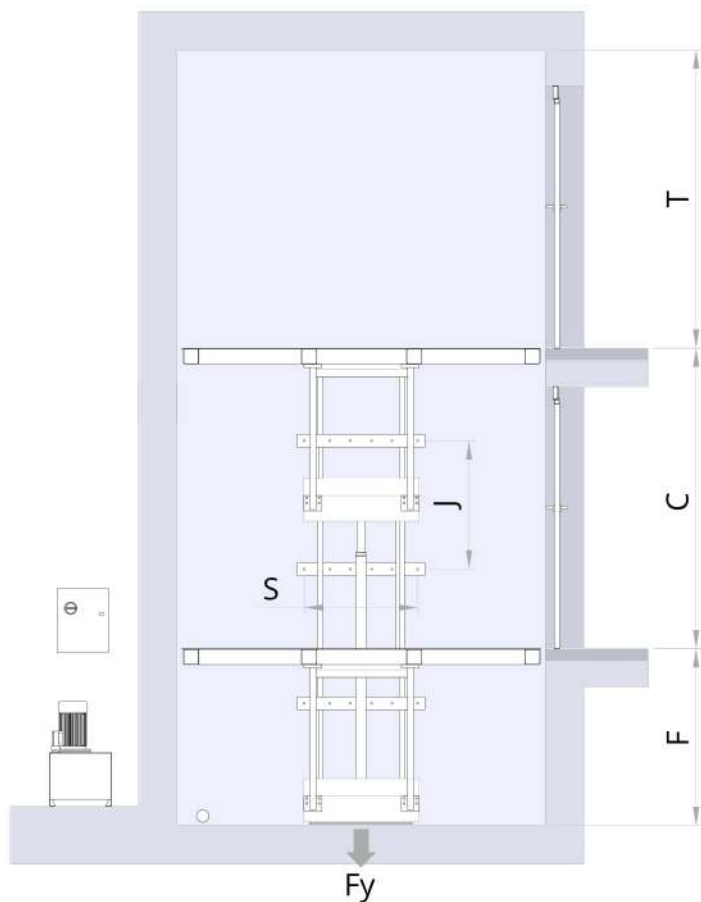

### System arrangement

PREPARE POWER 3F+T+N SWITCH AUTOMATIC MAGNETOTHERMIC WITH DIFFERENTIAL CURVE "C", ID = 0.3A

Motor	Tension functioning	Starter	Suggested switch*	Rated current	Current starter
3 kW	380 V - 3ph	Direct	4x16A id=0,3A	5	22
4 kW	380 V - 3ph	Direct	4x16A id=0,3A	8	25
5,5 kW	380 V - 3ph	Direct	4x16A id=0,3A	11	35

# UP20-25 STD for goods only

# UP20-25 SPB with operator on board

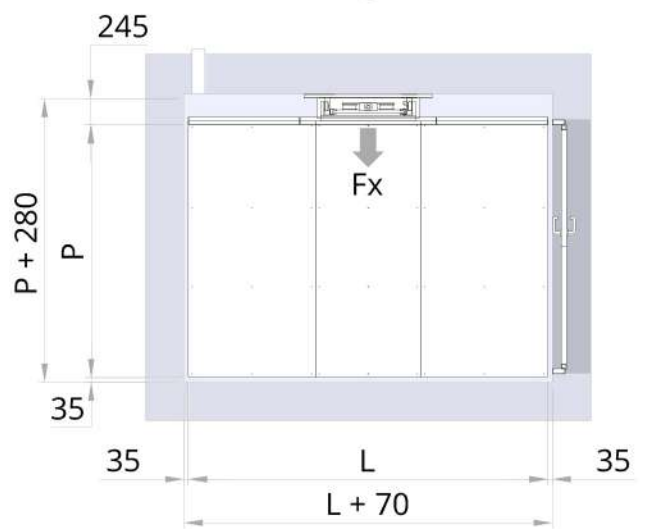
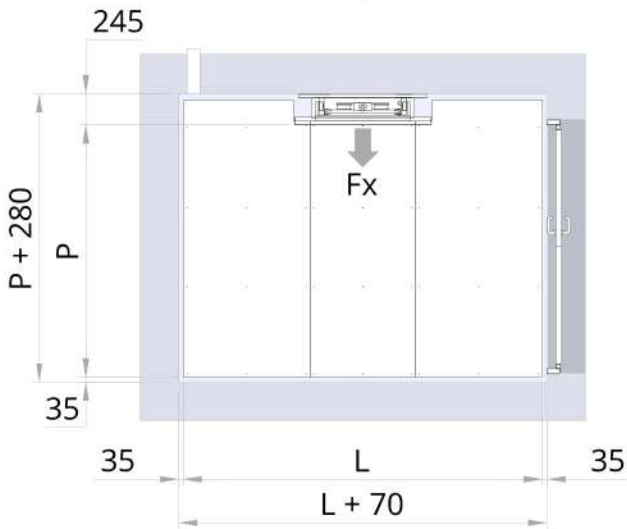
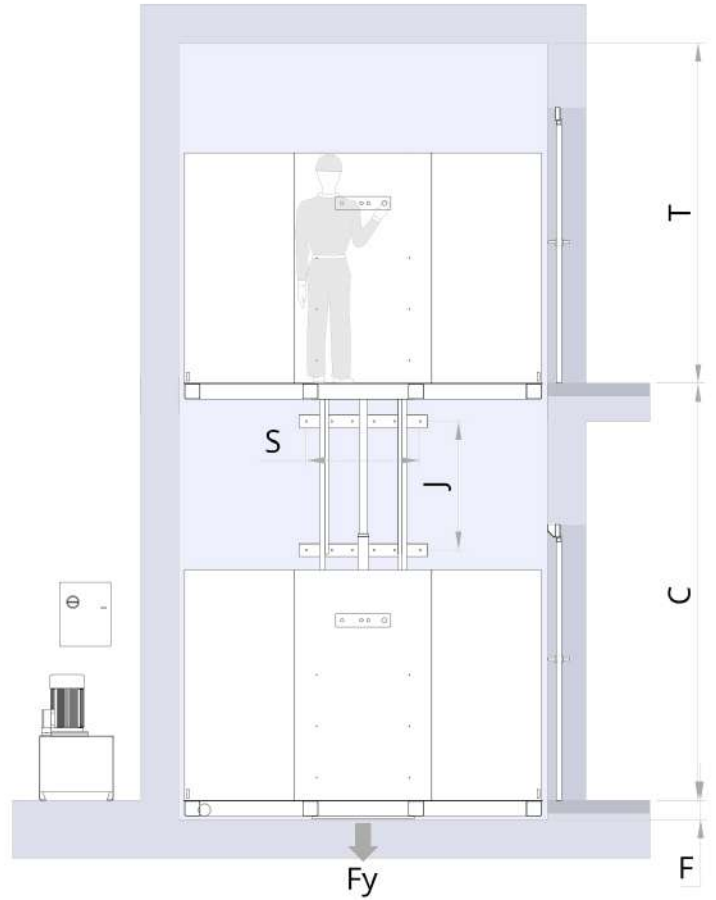
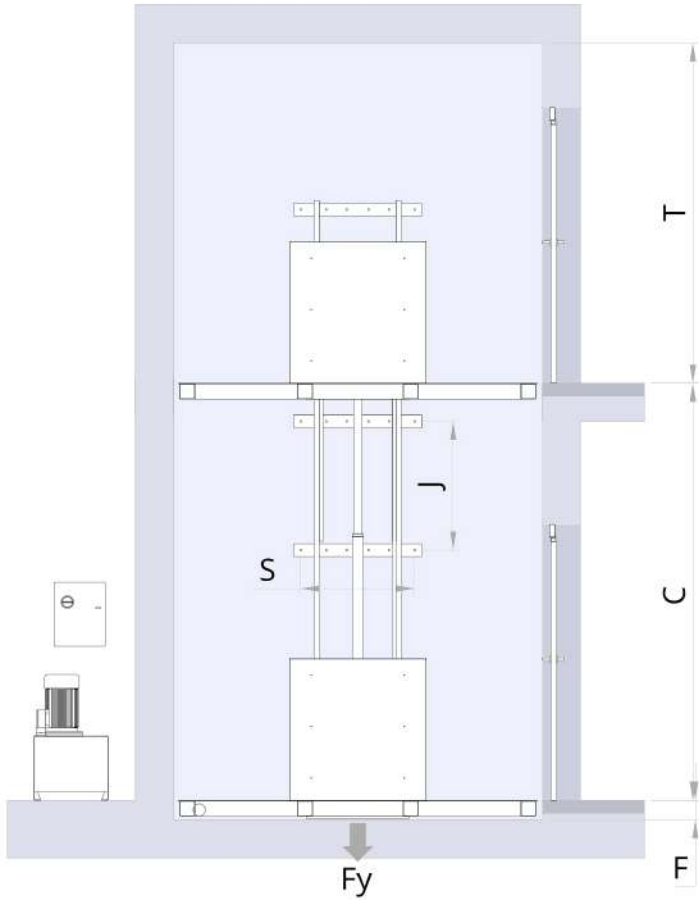

## Max dimensions

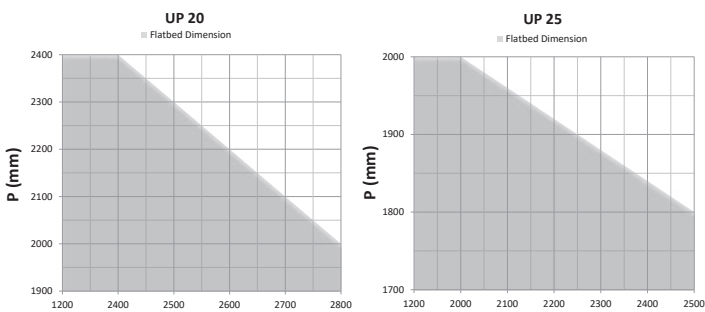

## Loads on wall (Fx)

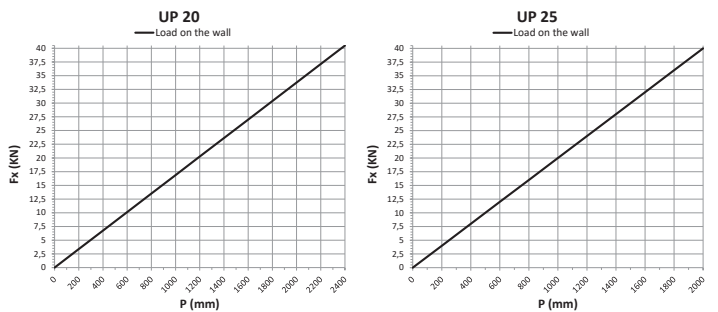

## UP20-25 R STD for goods only with reverse trolley

## UP20-25 R SPB with operator on board and reverse trolley

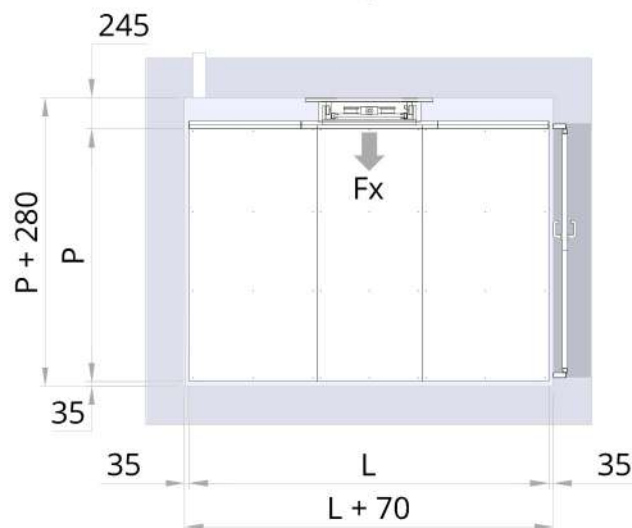
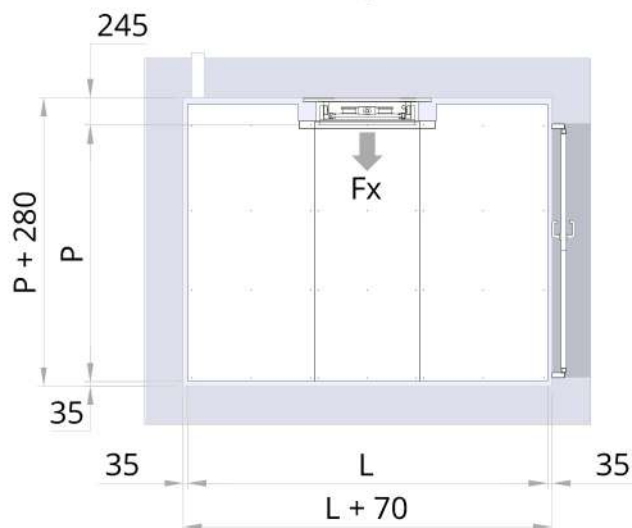
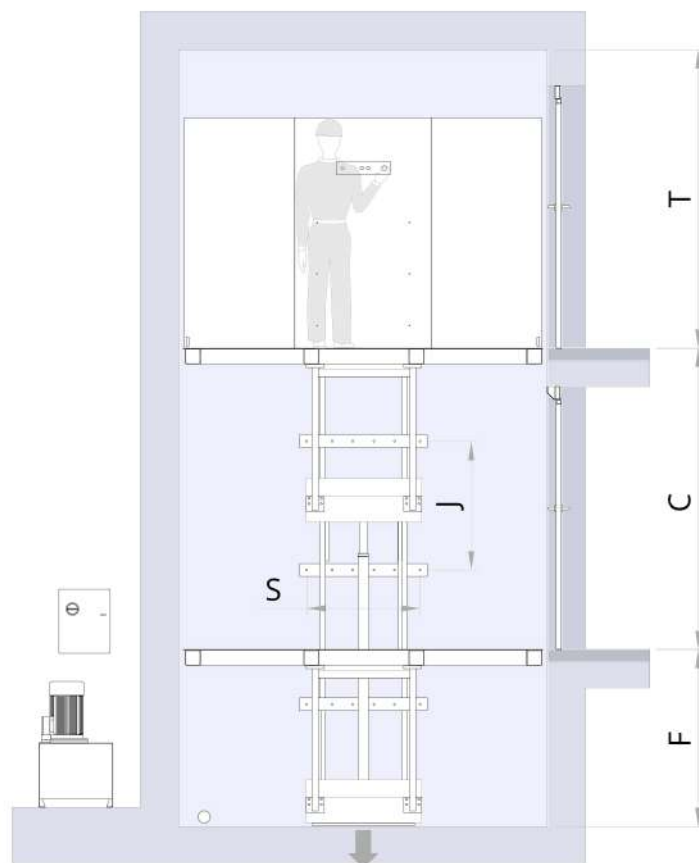
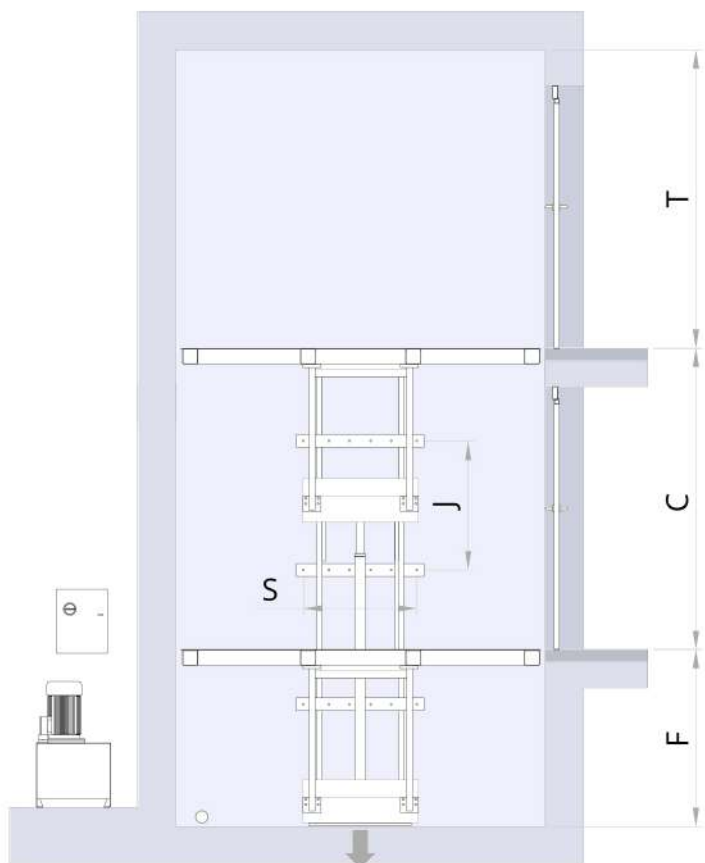

### System arrangement

PREPARE POWER 3F+T+N SWITCH AUTOMATIC MAGNETOTHERMIC WITH DIFFERENTIAL CURVE "C", ID = 0.3A

Motor	Tension functioning	Starter	Suggested switch*	Rated current	Current starter
3 kW	380 V - 3ph	Direct	4x16A id=0,3A	5	22
4 kW	380 V - 3ph	Direct	4x16A id=0,3A	8	25
5,5 kW	380 V - 3ph	Direct	4x16A id=0,3A	11	35

# DL2 Smart STD for goods only

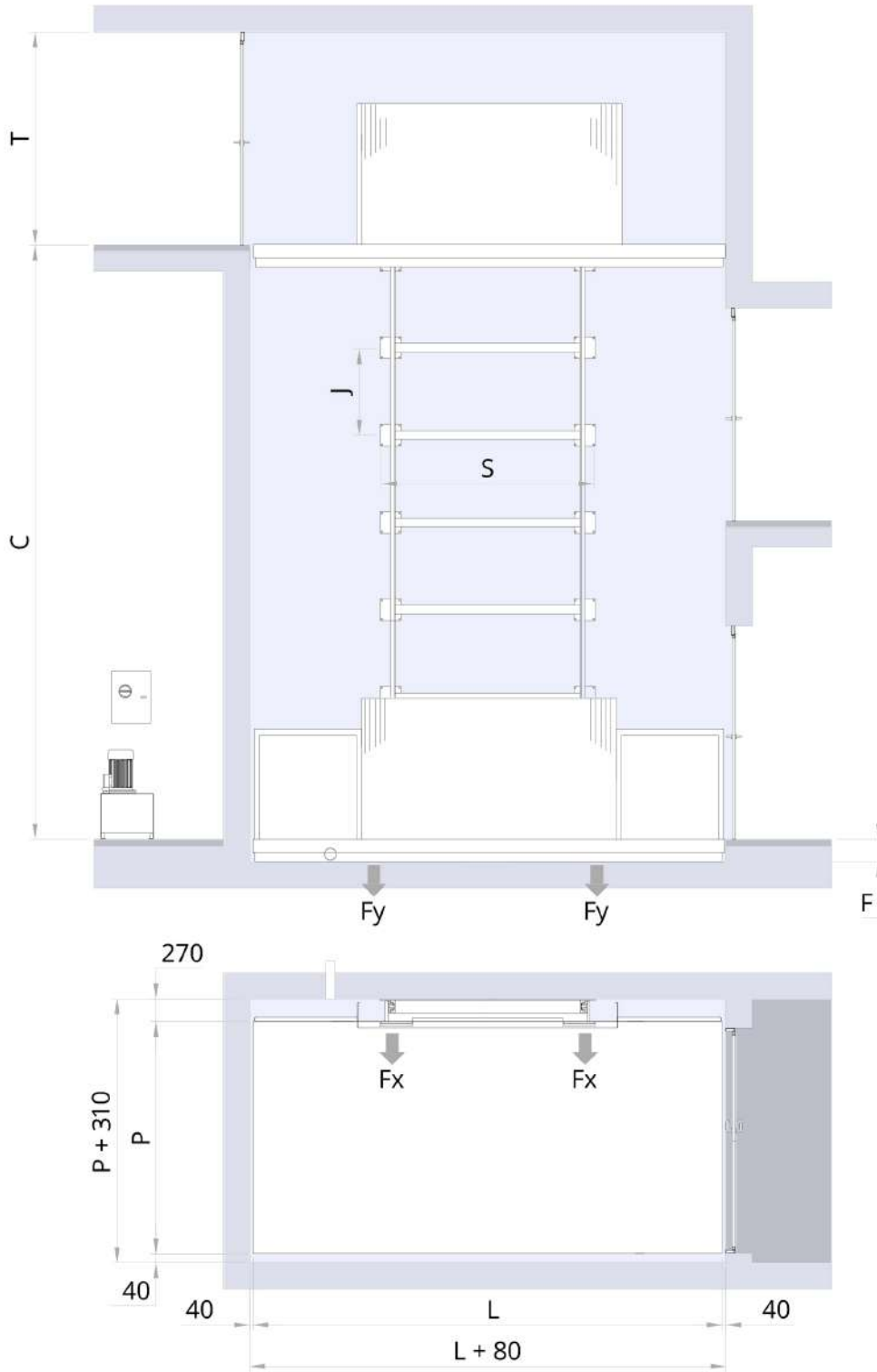

Max dimensions

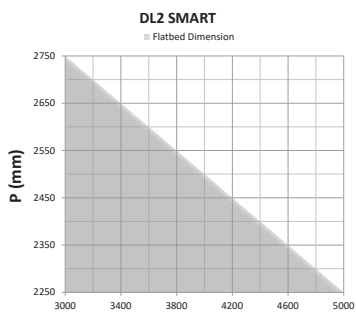

Loads on wall (Fx)

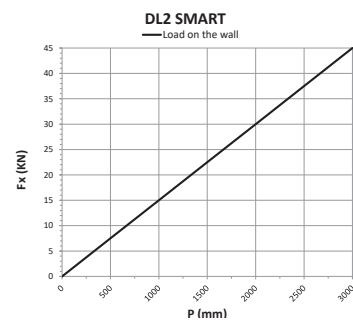



## DL2 Smart SPB with operator on board

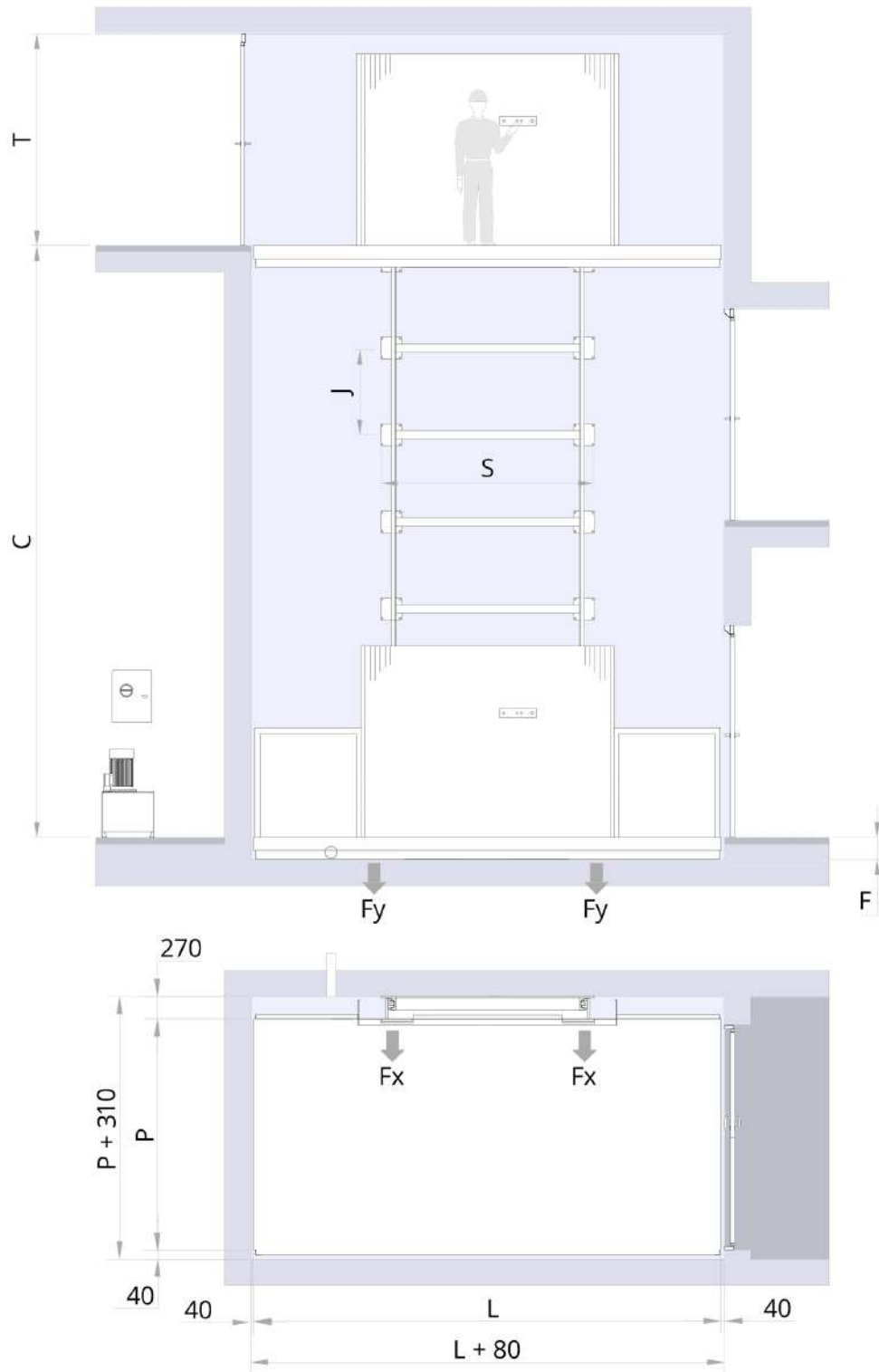

### System arrangement

PREPARE POWER 3F+T+N SWITCH AUTOMATIC MAGNETOTHERMIC WITH DIFFERENTIAL CURVE "C", ID = 0.3A

Motor	Tension functioning	Starter	Suggested switch*	Rated current	Current starter
5,5 kW	380 V - 3ph	Direct	4x16A id=0,3A	11	35
7,5 kW	380 V - 3ph	Direct	4x16A id=0,3A	14,5	45
9,2 kW	380 V - 3ph	Direct	4x16A id=0,3A	18	56

# DL2 STD for goods only

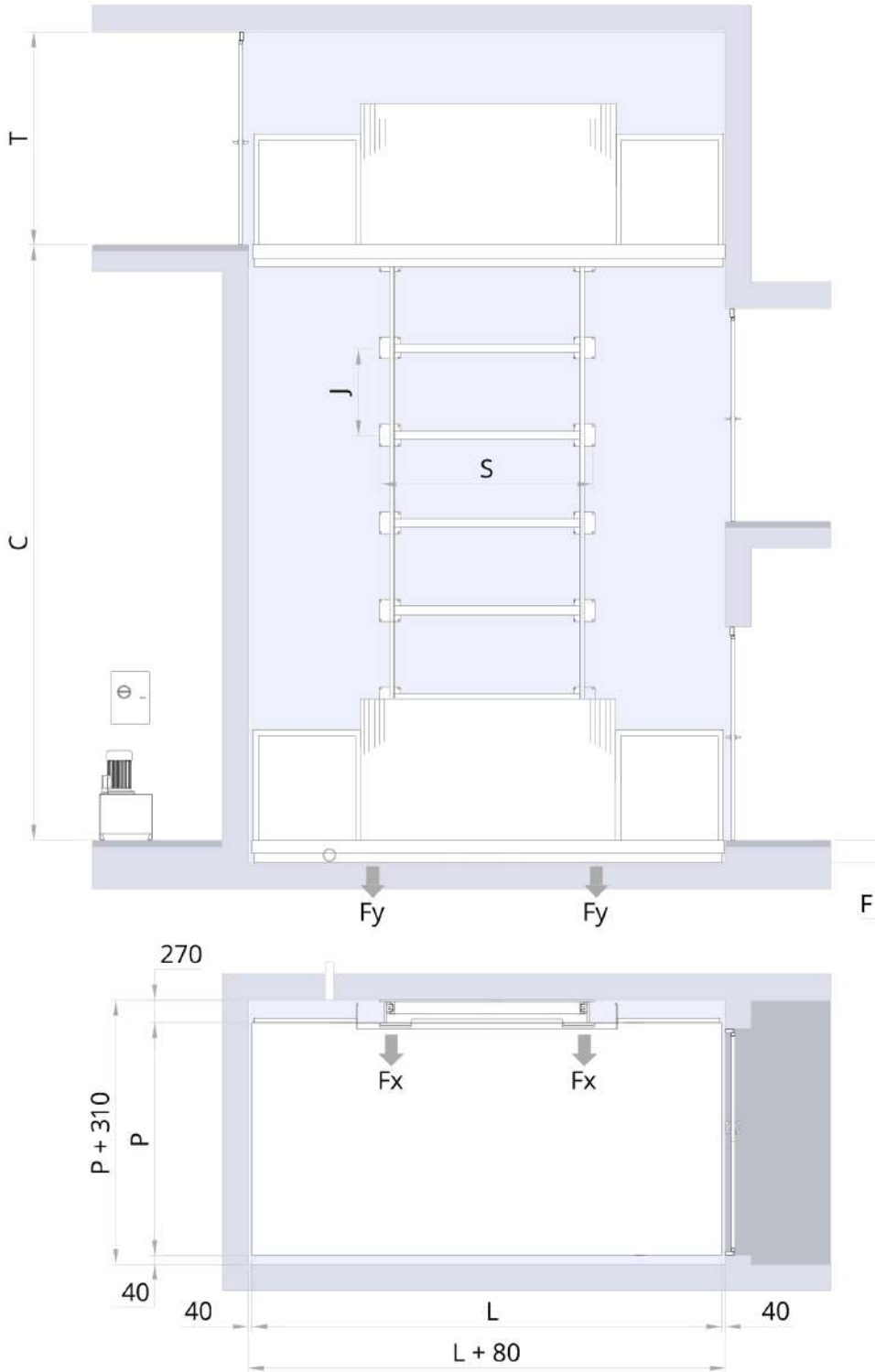

Max dimensions

Loads on wall ( $F_x$ )

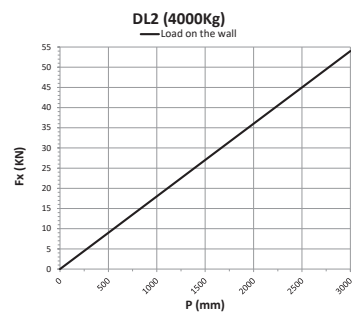
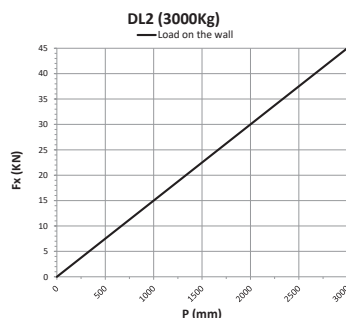
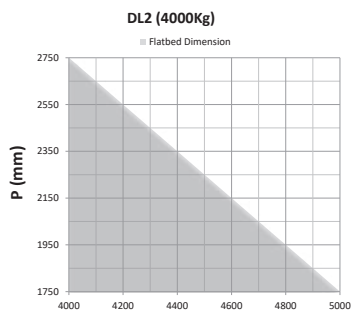
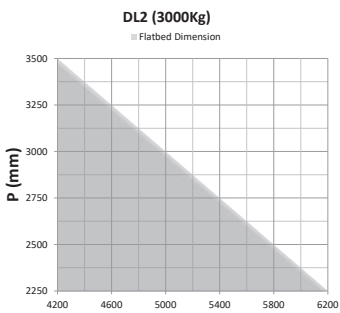

## DL2 SPB with operator on board

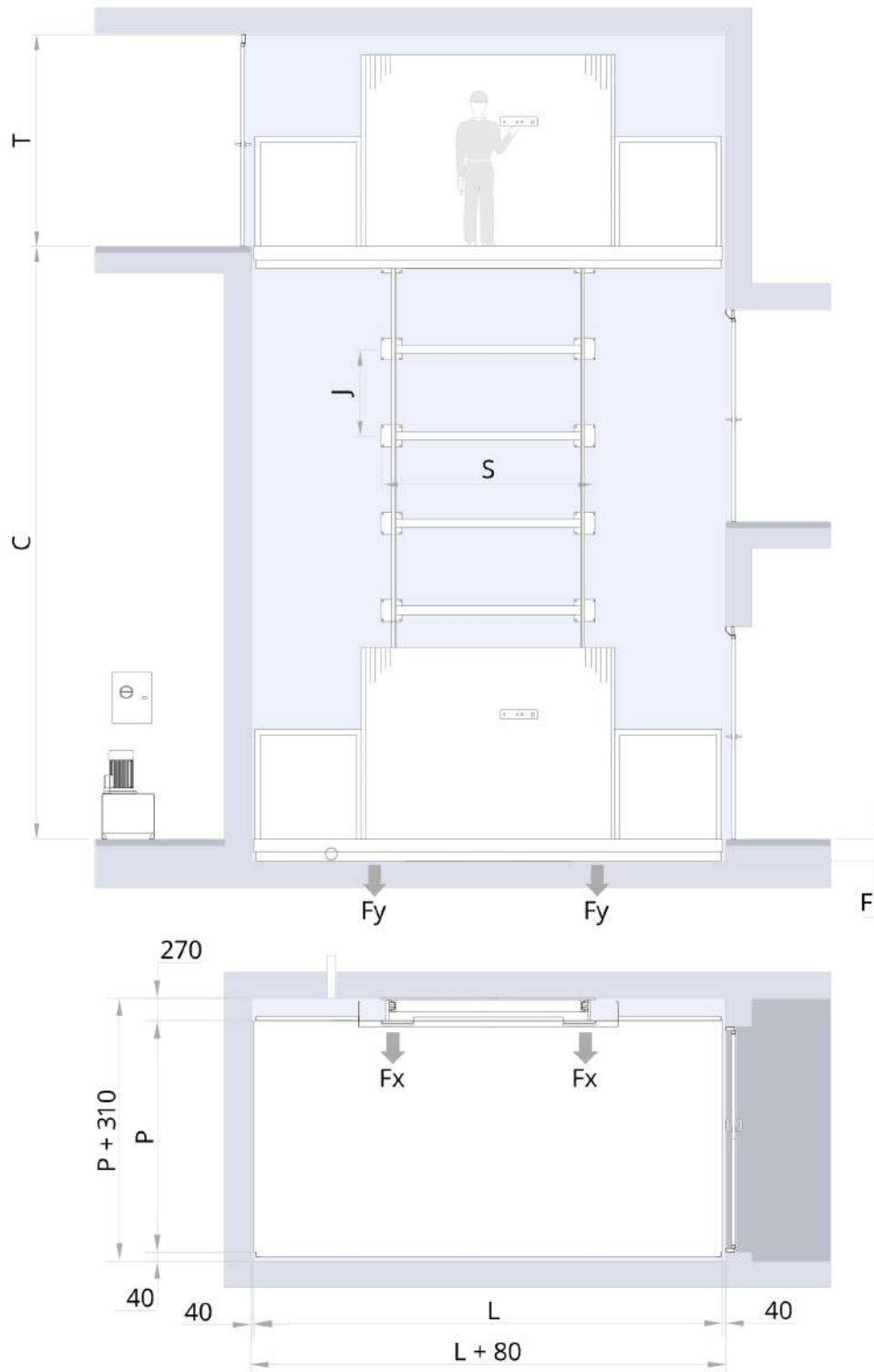

### System arrangement

PREPARE POWER 3F+T+N SWITCH AUTOMATIC MAGNETOTHERMIC WITH DIFFERENTIAL CURVE "C", ID = 0.3A

Motor	Tension functioning	Starter	Suggested switch*	Rated current	Current starter
5,5 kW	380 V - 3ph	Direct	4x16A id=0,3A	11	35
7,5 kW	380 V - 3ph	Direct	4x16A id=0,3A	14,5	45
9,2 kW	380 V - 3ph	Direct	4x16A id=0,3A	18	56

# DL4 STD for goods only

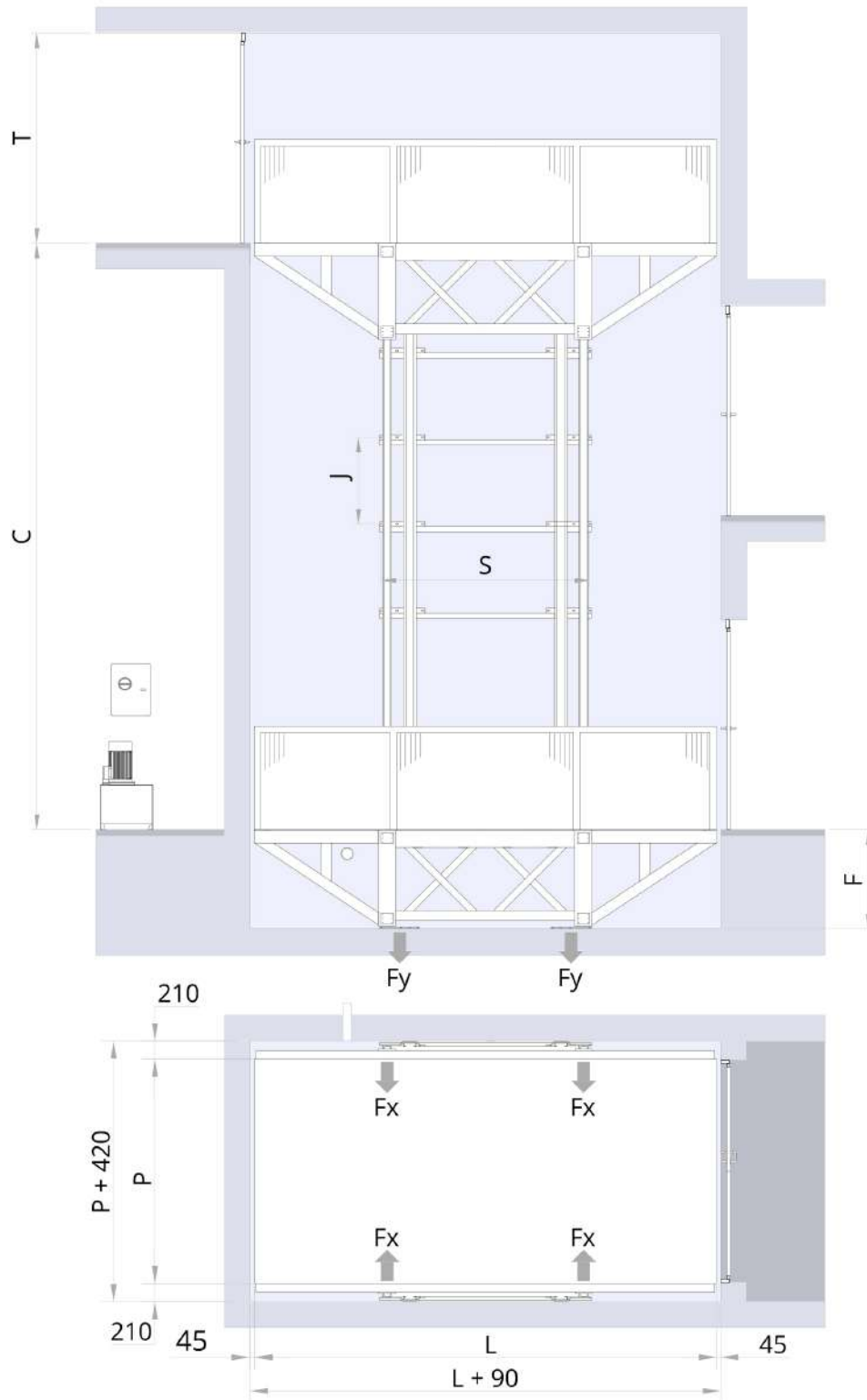

## Max dimensions

FLATBED DIMENSION AND MAX STROKE

Model	D (mm)	W (mm)	MAX S (mm)
DL4	3000	6000	16000

## Loads on wall (Fx)

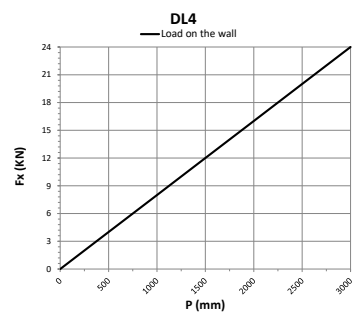

## DL4 SPB with operator on board

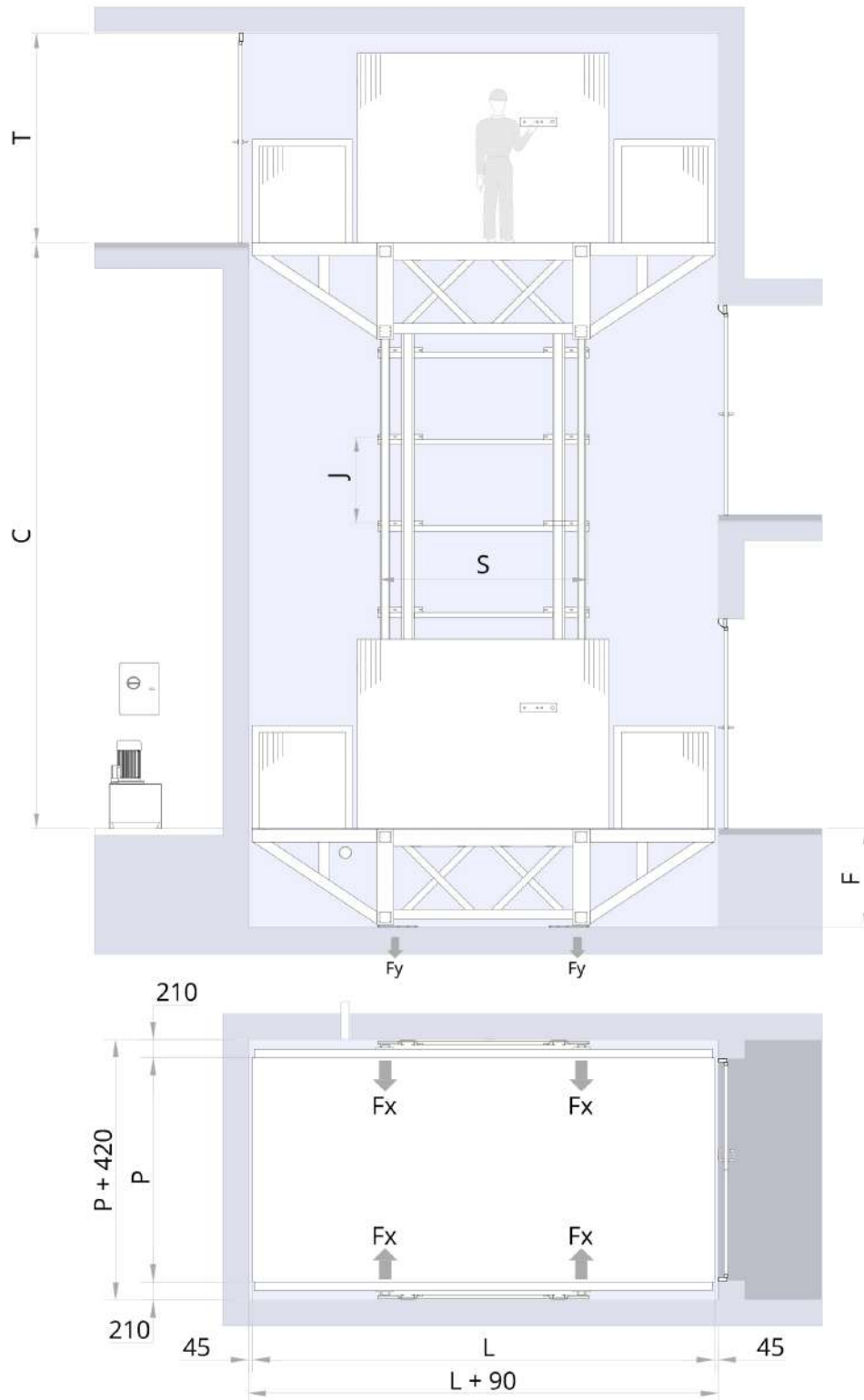

### System arrangement

PREPARE POWER 3F+T+N SWITCH AUTOMATIC MAGNETOTHERMIC WITH DIFFERENTIAL CURVE "C", ID = 0.3A

Motor	Tension functioning	Starter	Suggested switch*	Rated current	Current starter
5,5 kW	380 V - 3ph	Direct	4x16A id=0,3A	11	35
7,5 kW	380 V - 3ph	Direct	4x16A id=0,3A	14,5	45
9,2 kW	380 V - 3ph	Direct	4x16A id=0,3A	18	56

## UP3 RT STD for goods only

## UP3 RT SPB with operator on board

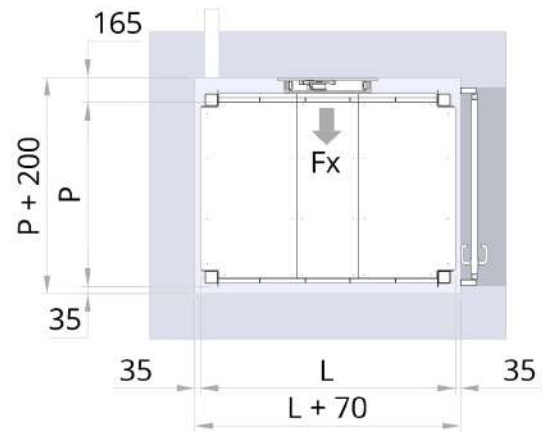
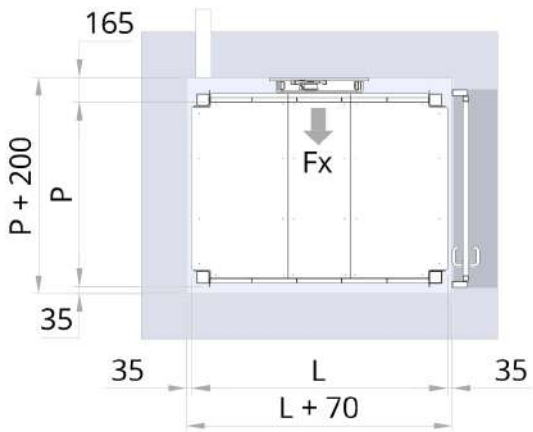
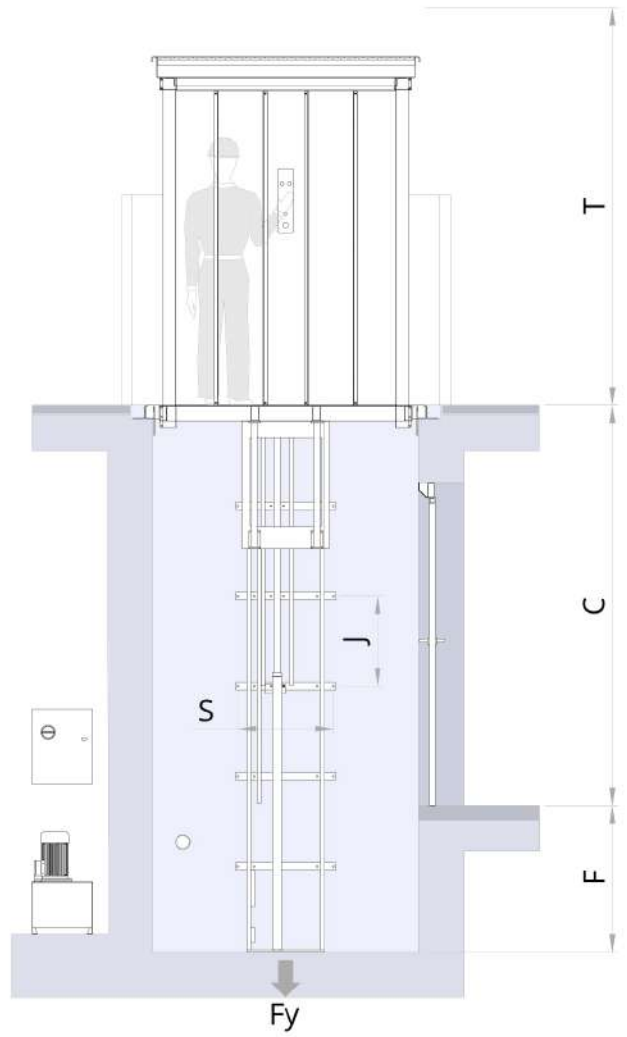
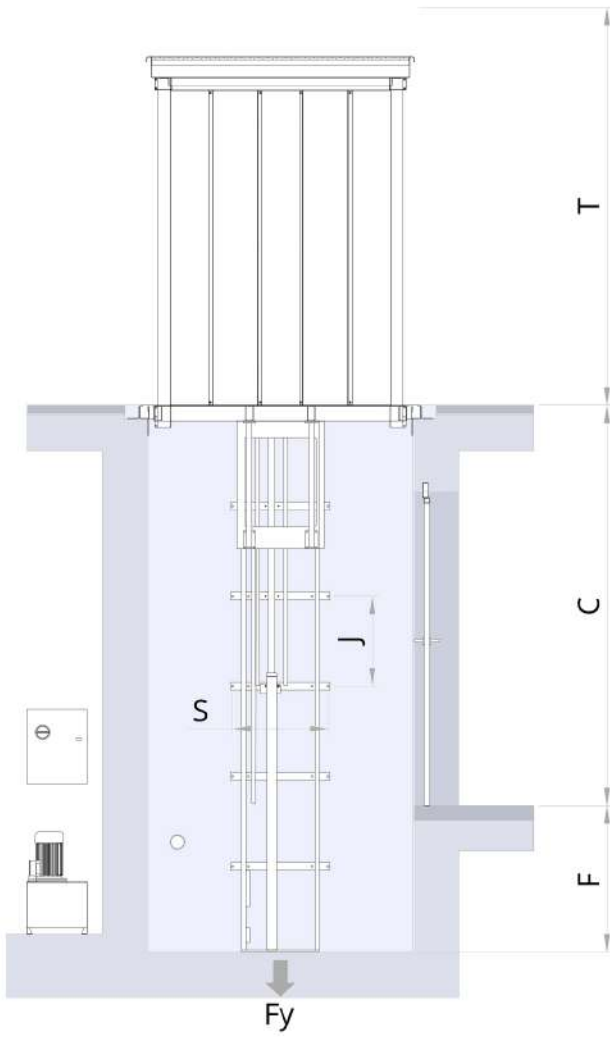

### Max dimensions

### Loads on wall (Fx)

FLATBED DIMENSION AND MAX STROKE

Model	D (mm)	W (mm)	MAX S (mm)
UP3 RT	1300	1700	7000

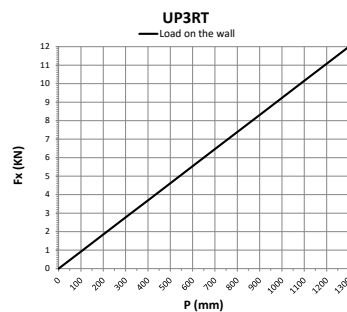

# UP5-10 RT STD for goods only

# UP5-10 RT SPB with operator on board

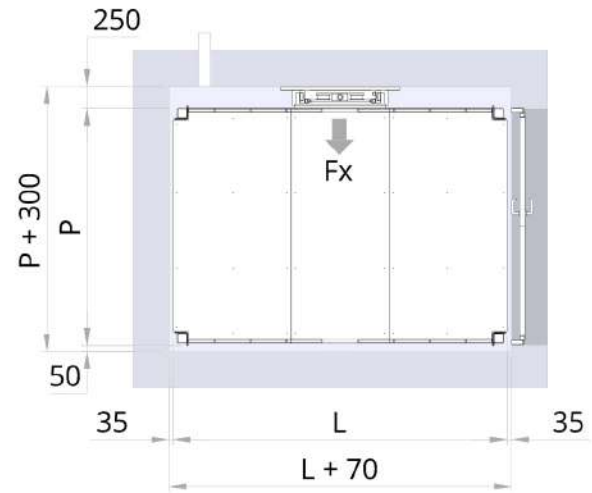
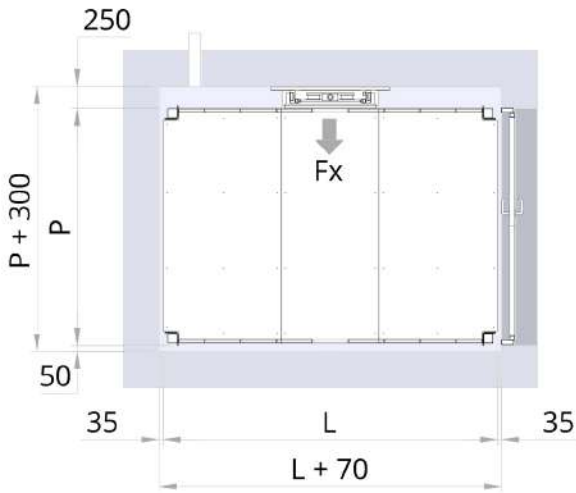
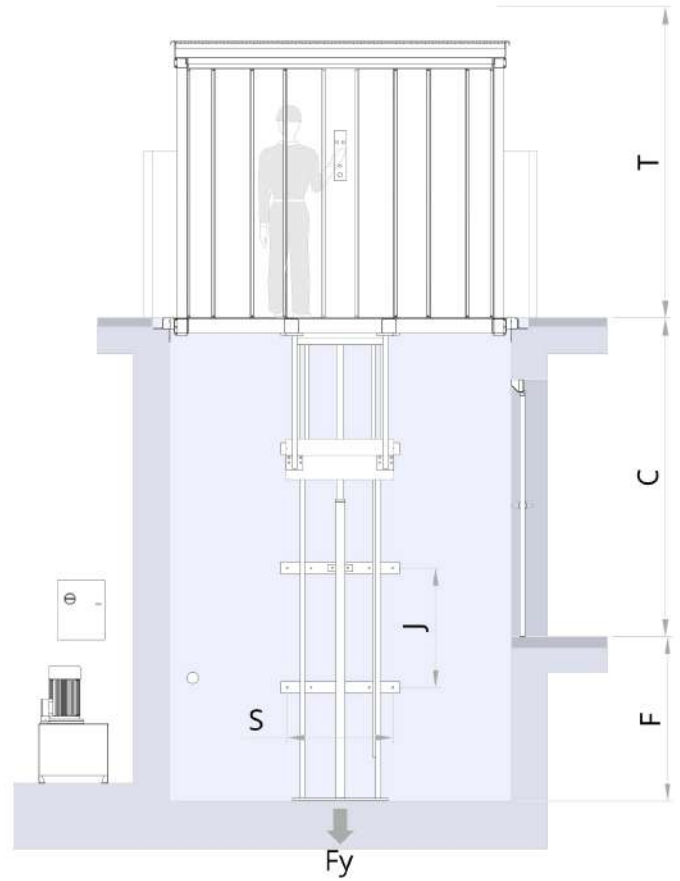
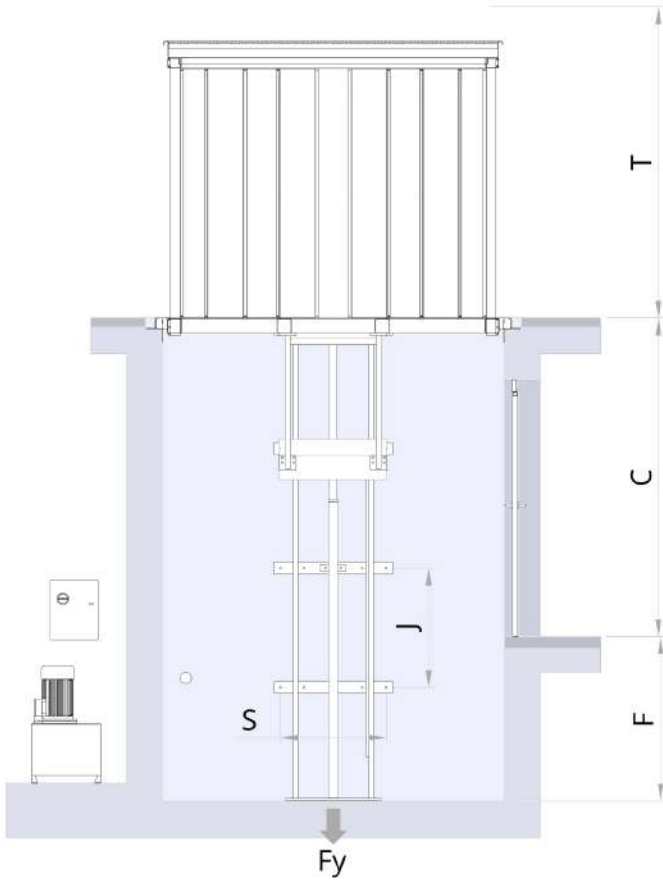

Max dimensions

Loads on wall (Fx)

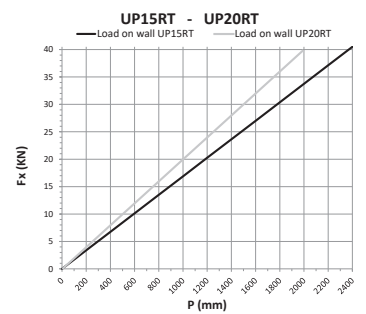
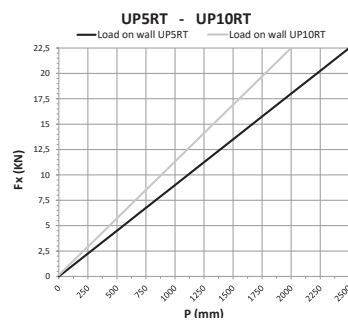
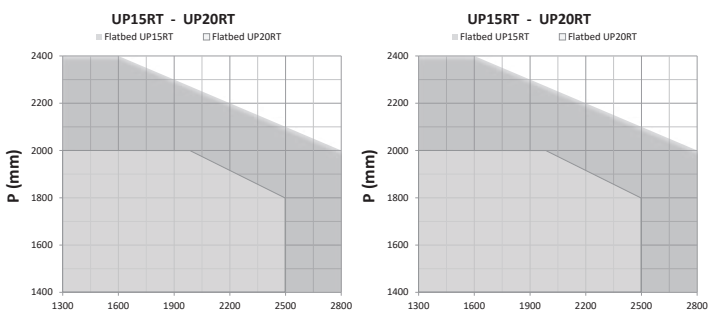

## UP15-20 RT STD for goods only

## UP15-20 RT SPB with operator on board

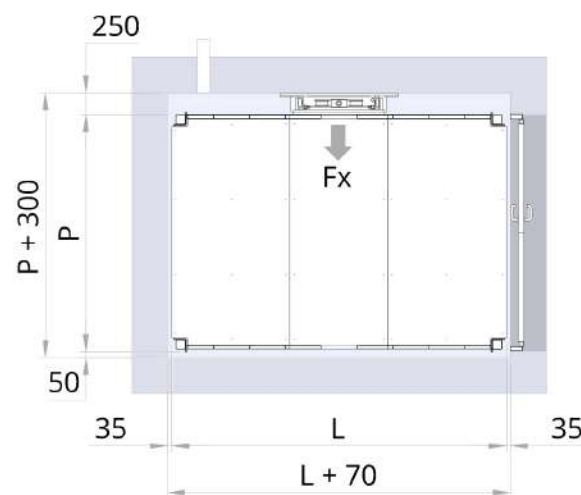
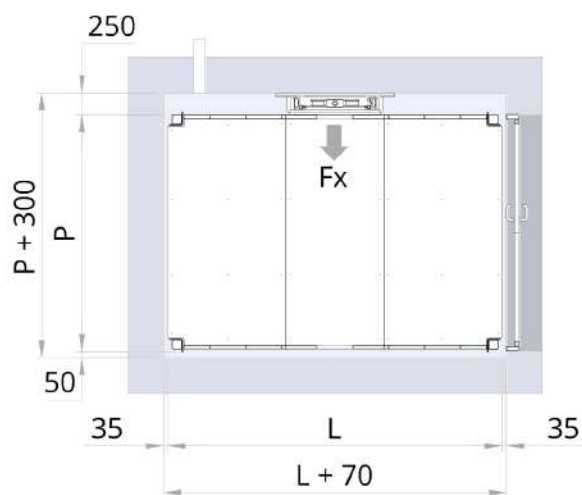
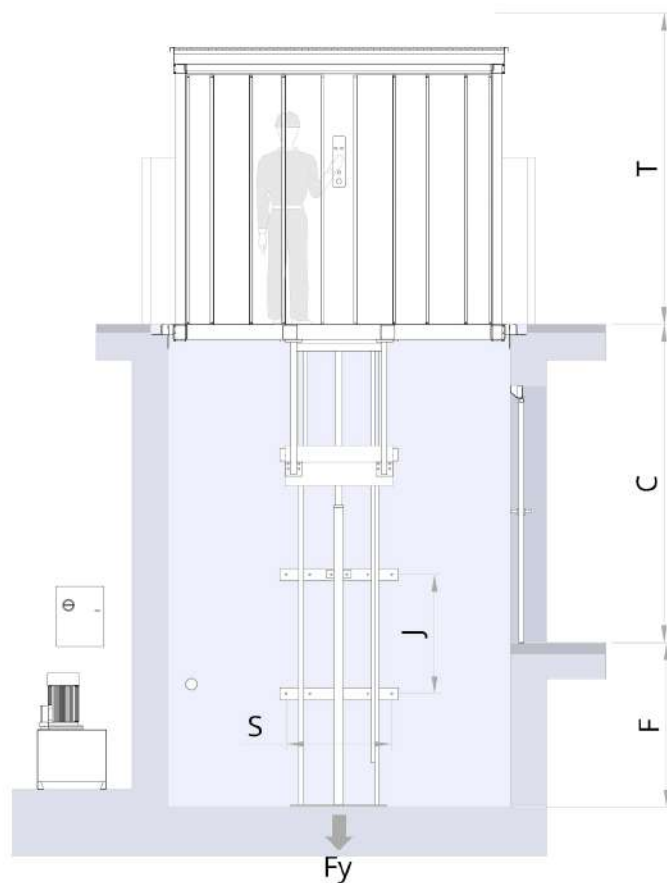
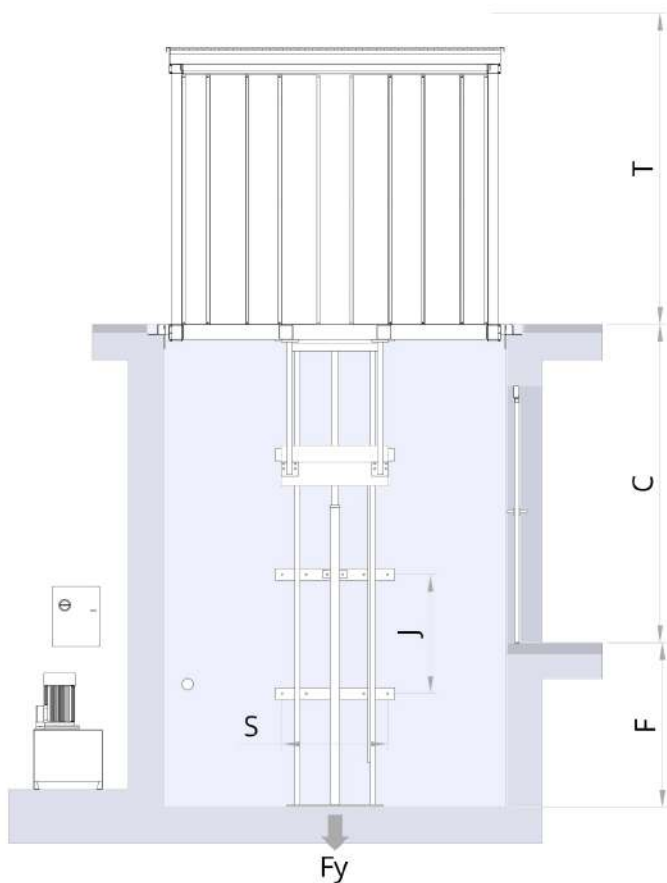

### System arrangement

PREPARE POWER 3F+T+N SWITCH AUTOMATIC MAGNETOTHERMIC WITH DIFFERENTIAL CURVE "C", ID = 0.3A

Motor	Tension functioning	Starter	Suggested switch*	Rated current	Current starter
2,2 kW	220 V - 1ph	Direct	2x16A id=0,3A	10,5	32
3 kW	380 V - 3ph	Direct	4x16A id=0,3A	5	22
4 kW	380 V - 3ph	Direct	4x16A id=0,3A	8	25
5,5 kW	380 V - 3ph	Direct	4x16A id=0,3A	11	35



